

Fall Fashion News Afoot



Gotham

Fitting compliment to this fall's gentle look... a beautifully shaped suede pump, lustre trimmed, fashion's newest news.

Fame

What a delightful way to combine fabulous flattery and great chic! It's the new open look-with-a-difference that's going places this fall.

Bally Ho

A great classic, tailored to a perfectionist's taste. Smart companion for daytime costumes, tailored or casual. All shoes are by De Liso Debs and available in Birmingham at Juhlards, 6558 Telegraph Road.

Old-Time Fair Staged by Historical Group

Stepping back into the pages of history will be Mrs. Robert W. Brandon, of 2674 Pine Hill Drive, Birmingham, when, in her gown of the 1800's, she presents an authentic demonstration of candle making in the Old Manor House at the Detroit Historical Society Guild's "A-Fair to Remember" on October 3.

Mrs. Brandon will share the legend of the bayberry candle and

take visitors back into the pages of history for an understanding of the ways of their forebears.

Children and adults will have an enthusiastic time picking and choosing at the "A-Fair," for there will be many booths, special exhibits, demonstrations, and food. Featured will be a booth with framed original autographs and words to live by from the pens of Henry Ford II, Cardinal Spellman, Mrs. Jacqueline Kennedy, John Steinbeck and others.

All this will be held in Detroit's Historical Museum, Woodward at Kirby. The time is Saturday, Oct. 3, 9 a.m. to 6 p.m., and the admission is free.

Pastor Will Speak At Lutheran Church

The first fall meeting of the Women's Society of Redeemer Lutheran Church will be held Oct. 1 in Fellowship Hall at 12:30 p.m.

Dessert will be served by the new officers, president, Mrs. Edwin Schuck, vice president, Mrs. Lowell Heisterman; secretary, Mrs. Owen Henkle and treasurer, Mrs. John Barnes.

Plans and committees for the year will be announced by Mrs. Schuck. Highlight of the day's program will be a talk by the pastor, Rev. Theo. Wugzaer, Jr.

6-D THE BIRMINGHAM (MICH.) ECCENTRIC Sept. 24, 1964



Forget Your Diet—Serve a Torte Treat!

Forget the calories, just this once, and treat your family to Chocolate Meringue Torte. This rich dessert is just too good to be missed.

The "crust" is a frothy baked meringue. The creamy smooth filling is a double chocolate... chocolate milk and chocolate bits. Pipe with whipped cream.

CHOCOLATE MERINGUE TORTE

3 egg whites
Dash of salt
1 teaspoon cream of tartar
1 cup sugar
1 teaspoon vanilla
1 cup whipping cream, whipped and sweetened

Preheat oven to 450°. Beat egg whites until frothy. Add salt and cream of tartar; beat until egg whites stand in soft peaks. Add sugar, a tablespoon at a time, beating well after each addition. Beat 15 minutes after all sugar is added. Add vanilla. Spread meringue in buttered 9-inch oven pie pan. Put

in oven; turn off heat immediately. Leave in 4-5 hours or overnight. DO NOT PEEK! Spoon whipped cream into meringue shell. Spoon in creamy chocolate filling. Cover with foil; let stand in refrigerator 8 hours.

CREAMY CHOCOLATE FILLING

2 cups chocolate milk (or drink)
1/4 cup flour
1/4 cup sugar
1/4 teaspoon salt
3 egg yolks, well beaten
1/2 cup semi-sweet chocolate pieces
1 teaspoon vanilla

Combine chocolate milk, flour, sugar and salt. Bring to boil over low heat, stirring constantly. Stir half of hot mixture into egg yolks. Add to remaining hot mixture. Bring to a boil; cook 1 minute, stirring constantly. Remove from heat. Add chocolate pieces and vanilla. Chill.

B'ham Alumnae Mark Barnard's 75th Year

Barnard College alumnae from the Birmingham-Bloomfield area will gather to celebrate the 75th anniversary of the school's founding at the Detroit Institute of Arts on Friday, Oct. 2.

He is recognized as an expert on Peter Paul Rubens and his most recent work is a two-volume publication, "Rubens: Selected Drawings." Dr. Held serves also on the editorial boards of "The Art Bulletin" and "The Art Quarterly."

The Founders Society of the Detroit Institute of Arts will host a reception in the Romanesque Hall following Dr. Held's lecture. Invitations to both events are being extended to those active in Detroit's cultural and educational life, including members of the Institute's Founders Society.

DR. JULIUS HELD

Highlight of the evening will be an illustrated talk on "The Sources of Hellenistic Art," delivered by Dr. Julius Held, professor of art history at Barnard at 8 p.m.

Mrs. Daniel Boone of Detroit is chairman of the Anniversary Celebration Committee for the Barnard Club, of which Mrs. John F. Gregory of Birmingham is president. Serving with Mrs. Boone from Birmingham are Mrs. Howard Bover, Mrs. William T. Gossett, Mrs. David H. Lynn, Mrs. Samuel S. Polk and Mrs. Parbury Schmidt.

DR. HELD holds posts in the world of art including the professorship of art history in the Graduate Faculty of Columbia University. He teaches also at the Metropolitan Museum of Art in New York City and has done original research and writing in Flemish, Dutch and German art.

Advertisement

ART FOR ART'S SAKE

By CAROLYN HALL
Special Writer

Sculptor Schmidt Leads Ideal Life: Teacher, Artist

What could be an ideal life for an artist? Julius Schmidt, sculptor and head of the sculpture department at Cranbrook Academy of Art, feels he has the answer.

He does not need to teach to earn a living for his wife and new daughter. His cast metal sculpture is successful both in world-wide competitions and in his New York Gallery.

Conversely, he needn't sculpt for money since he enjoys the atmosphere of a community of artists at Cranbrook where he constructed the foundry in the only new building added to the academy of art in many years.

SCHMIDT, A continuous and productive artist, has been casting bronzes (in various alloys and metals) all summer for his current exhibition at the Franklin Siden Gallery in Detroit which runs until October 16.

The show includes twenty sculptures and several drawings and reveals an expert craftsman a superbly proficient in casting and handling his medium.

All of the works have a basically simple shape: a tall column, a flat panel, a helmet or an anvil. None are representative in the standard sense, only reminiscent or interpreted by the viewer.

THE SIMPLICITY of the overall form tends to focus attention on the surface treatment. Here, a myriad of protruding and indented tiny shapes, mechanical in type, texture the entire surface.

The sculptures are encrusted with exquisite patinas: blue, green, metallic and black. Acids and chemicals reacting with the metal build up an aged protective surface.

How refreshing to see a contemporary artist using mechanical forms, not in fear of being

ELSEWHERE in Detroit, opening season is beginning. Arwin's Gallery reopens refurbished on Robinson's second floor with a group show. The artist market opens Sept. 25 with its regulars.

Oakland University is showing recent paintings by Kichie Usui, Cyril Miles' paintings and collages from the bible, and Greek mythology opens at Eastern Michigan University, Ypsilanti.

"Eyes on New England" opens at the Little Gallery in Birmingham Sept. 29. C. Shepard T. opened

Junior Symphony Begins Season In Southfield

Southfield Junior Symphony began fall rehearsals last Saturday in the Southfield High School music room. Richard Brown, music instructor in the Southfield schools, directs the symphony, which had a membership of 70 teenagers last year.

The group meets for rehearsals from 9:30 a.m. to noon each Saturday during the school year, and presents two concerts a year—in January and in April.

Eleven members of the group received Junior Symphony scholarships last summer. Ten of them were students at Interlechen National Music Camp and one member studied at Michigan State University.

MEMBERSHIP in the group is open to any student interested in performing symphonic music who auditions with Brown and performs satisfactorily.

Appointments for auditions may be made by contacting Brown at 25821 Briarbank, Southfield, or through any members of the Junior Symphony board.

New officers of the Association are Mrs. Fay Gifford, 18515 San Jose, Lathrup Village, president; Mrs. Ernest J. Coverdill, 28452 Woodworth Way, Lathrup Village, vice-president; Mrs. John B. Heaton, 26651 Meadowbrook Way, Lathrup Village, treasurer; Mrs. Glenn S. Farison, 29065 W. Eleven Mile Road, Southfield, recording secretary; Mrs. Quenton Hamilton, 19051 Dolores Road, Lathrup Village, correspondence secretary; Mrs. Dorman B. Dickerson Jr., 4005 Wing Lake Road, Birmingham, historian and publicity chairman.

When your clothesline needs washing, coil it around a washboard or a piece of wood about that size. Stand it in a tub of hot soapy water, and scrub it thoroughly with a brush. To avoid twisting or tangling, let it dry right on the board, and put it up again when it's completely dry.

at the Racz Gallery on Grand Circus Park. And Nicholas Buhalis is having a sale in his studio before departing, 9 a.m. to 9 p.m. this week end (on Harmonie Park near Hanamania, The Artist's Market and Adler-Schnee's).

CUSTOM BUILT FOR ELEGANT LIVING



A CONTEMPORARY COLONIAL, at 862 Glenhurst in Birmingham

Contemporary on the outside, as you can see—wait till you see the inside. 4 bedrooms (the master has its private bath and dressing room) two additional baths to serve you. Huge Living Room and Dining Room, a private study for retreat, and a Family Room with a magnificent fireplace leading to outside patio and trees and more trees. And wait till you see the stairway... and it's all ready now for immediate occupancy.

Priced at \$44,500

SNYDER & SNYDER BUILDERS, INC.
863-9629



Birmingham Schools in "GREENTREES NORTH"

Consider the advantages of this area of fine homes:

- Birmingham schools
- Minutes from Birmingham and Northland Shopping Centers
- In Suburban North Woodward
- Easy access to Southfield and John C. Lodge Freeways
- Parochial Schools and Churches nearby
- City water and sewers
- Choice from Colonials, Tri-Levels and Ranches
- Homes have family rooms, natural fireplaces, 2-car attached garages, dishwashers and other features



The Camden, one of five models, is a four-bedroom Colonial with 2 1/2 baths, 2-car attached garage, separate dining room, family room with natural fireplace... storms and screens, built-in Hotpoint dishwasher, oven and range and dozens of other features... 2031 Sq. Ft. of living area plus full basement. Its price is \$29,500.00 or as low as \$28,125. Other models are priced from \$27,500.00 or as little as \$26,000.00.

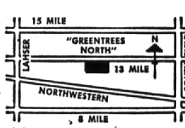

MARK BUILDERS, INC.

10222 WEST MANICHOLES ROAD - DETROIT, MICHIGAN
MODEL PHONE: 844-4140 • OFFICE: MI 4-0888

ROMANESQUE



Here... at last... is a way of life revised for the critical few whose standards demand both custom quality and outstanding design. From the instant you enter the private intimacy of the authentic open-roofed Roman courtyard... you'll compare the Pompeian with homes priced well over \$60,000. Architectural design is ingeniously fused with patios and courtyards to expand family living and entertaining... rooms are of imposing proportions... are informal and formal wings are superbly grouped and traffic engineered to permit simultaneous use. A luxurious Roman sunken tub and bath... unique massage-sun-exercise lounge... are but a few of the startling innovations. Discover the rest for yourself this weekend at Franklin Corners.

THE POMPEIAN HOUSE

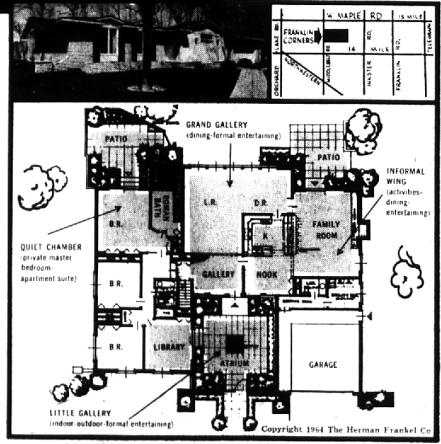
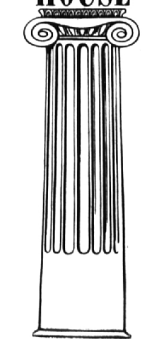

FRANKLIN CORNERS

6 MODEL HOMES ON DISPLAY from \$29,900
Models Open Daily, Noon to 8 p.m. • Sunday, Noon to 8 p.m. • Saturday, Noon to 6 p.m.
INTERIORS BY ROBINSON PUMPHREY • Copyright 1964 The Herman Frankel Company
BIRMINGHAM SCHOOLS AND ADDRESS • MAIN OFFICE: WA 6-3500 • SALES OFFICE: WA 6-3502

the herman frankel ORGANIZATION