

Forest Has Interesting 'Family Tree'

By Lydia King Frehse
Special Writer for The Birmingham Eccentric

WALLOON LAKE—Here in the North Woods we live in the midst of a plant association which is fast becoming a rarity—a remnant of virgin beech-maple forest.

The great trees thick-crowned and tall, stand unimpeded as they stood before the " lumbering off " at the turn of the century. In the early 1800's when the young Audubon first roamed the sunlit woods of Kentucky, the hardwood forests stretched from the Atlantic coast to the prairie. Then its branches were filled with the rustle of passenger pigeon's wings, and wild game of many species found food and shelter within its close fastness.

HERE WE CAN yet touch the great boles of beech and sugar maple as we walk in the shadowy forest-ides. In spring they are lighted by the beauty of trillium, of violet, of yellow lady's slipper. Their summer canopy shelters the shade-loving ferns and such under-story plants as aralia, red-berried elder and bladder-tongue.



Mrs. Frehse

Autumn reveals the colorful fruits of dionaea, partridge vine and Jack-in-the-Pulpit.

OUR HARDWOOD forest is of ancient lineage. To understand its history you must go back with me some 100 million years to stand on the threshold of the "Cenozoic," our modern era. The place is Disco Island, 300 miles within the Arctic Circle. The climate is warm and humid. Much of the land is still under water and a great inland sea covers most of the area now occupied by our mid-western states.

A FINE HARDWOOD forest of such trees as sassafras, tulip, willow, poplar, oak and magnolia grows along its shores through what is now the Dakotas, Kansas and Nebraska and south as far as Texas.

From its northern point this same association of trees is pushing southward into Iceland, Scandinavia, Europe, Siberia and China. And if you go there today you can see these same families in circles radiating into all the continents, their identity measured by their relative distance from the parent Greenland forests of so long ago.

MILLIONS OF YEARS came and went while this great hardwood forest advanced, giving rise in Tertiary times to what many scientists believe was the most varied flora of all time.

Such violence of the earth's crust with its attending climate changes was the force which gave rise to the families of our modern flora as well as accounting for their dispersal around the world.

Along with the above mentioned families were growing a profusion of species of such present day trees as alder, beech, maple elm, linden, chestnut and ironwood. The record of one of the largest of early Tertiary plant associations is found in the Wilcox flora, which occurs along the coastal plain of the Gulf of Mexico from Alabama to Texas. This fossil record contains 545 described species belonging to about 182 genera and 82 families.

When one considers how incidental a fossil is, the realization dawns of what an amazing flora must have existed in this era some 40 millions of years ago.

AS THESE GREAT hardwoods advanced, the Coniferous forest decreased.

A less equitable climate now prevailed and the conifers with their less adaptable ways, their less sufficient naked seeds, could not compete with the broad-leaved plants with their more highly developed food production and their protected seeds with clever dispersal mechanisms.

AS OUR MODERN ERA progressed, great upheavals of the earth's crust and unparalleled volcanic action occurred which resulted in our present day system of mountain ranges, deserts, rivers and oceans.

Such violence of the earth's crust with its attending climate changes was the force which gave rise to the families of our modern flora as well as accounting for their dispersal around the world.

IN ORDER TO MEET and survive such barbarous and changing conditions the early hardwood species radiating from their sub-arctic centers, gradually gave way to shrubs, then to grasses and sedges and finally to wild flowers.

But this flora was to be faced with one more hurdle. Four times within the last million years, great continental glaciers swept southward over the earth's north temperate zone erasing or moving southward the existing flora.

With each ice retreat the plants re-established themselves over the re-sculptured earth. They could move only inch by inch as a seed travels, but in due time after the melting of the last glacier some 10,000 years ago, the tremendous adaptability and vitality of the evolved seed plants triumphed. They had passed yet another rigid test.

THUS IT TOOK anywhere from 40 to 100 million years for our present flora to establish itself. And our hardwood forests together with their ground cover plants are a part of its marvelous variety, form and structure.

B-D THE BIRMINGHAM (MICH.) ECCENTRIC August 22, 1963

Gallery

(Continued from 1-D)

Yiddish accent which colored an otherwise rather uninvolved monologue.

"The Bride" was played by Mary Lou Zieve of the Vanguard Theatre. The monologues would have made very good private readings, but to this reviewer they did not profit by being read aloud. This is essential in the theatre—a work must profit by being performed.

IN "ROOMMATES," Paul Winter played the lover and Mary Lou Zieve played the girl. It was a study of a man and woman too involved with their separate, dissatisfied selves to sustain the attraction which drew them together.

The girl starts early in the play that she lives with him "to be judged." Later she says, "I won't be here to make it nicer for him." She accuses him of not letting her be feminine. She is threatened by her roommate's intellectuality and tells us how, in a show of spitefulness, she likes to bring home McCall's to read just to annoy him away from her rather than reading herself of the Durrells and Henry Millers in his bookshelves.

HE IS NOT helpful either in perpetuating the cause of young love. He complains that her vocabulary is smaller than his, yet it is obvious that vocabulary is not all he requires from a woman, for he covets every pretty pair of legs that passes by.

He commits a grievous error in bringing home a female guest, unwanted by his roommate. "It's my house, too," she cries. And that's the trouble. It's his house and her house but not their house.

"Roommates" is a painfully realistic, intelligently drawn picture of the conflict of feminine ego versus masculine ego. The lack of mutual identity and trust becomes intolerable and they part.

It is a hard-hitting, poise and force of sentimentalism. "MAN BENEATH WOMAN" a monologue, was easily the most successful work of the evening. It was written expressly for the actor, Paul Stolarsky. A long-time admirer of Stolarsky, Mrs. Broner showed theatrical inspiration in this piece. Possibly this was because she meant it to be a vehicle for an actor.

Legal Notices

Hewlett, Hartman & Beier, Attys., Pontiac State Bldg., Pontiac, Michigan 48102.
STATUTE OF MICHIGAN - The Probate Court for the County of Oakland AID ELLIOTT SMITH, Decreee. At a session of said court, held at the Probate Court in the City of Pontiac, in said County, on the 15th day of August, A. D. 1963.
Present: Hon. Donald E. Adams, Judge of Probate.
Order appointing time for hearing. Notice is hereby given and it is hereby ordered that the time and place for hearing on claims against the above estate shall be the 15th day of October, 1963, at nine o'clock in the forenoon at the Probate Court in the Court House, at the City of Pontiac, Michigan.
All claims against the above estate are further notified and required to be filed with the clerk of said court and with the fiduciary of this estate, under seal and containing sufficient detail reasonably to inform the fiduciary of the nature and amount of such claim. It is further Ordered that notice be given to all persons interested in the estate, personally, or by mailing copies to mail with their registered or certified mail with return receipt addressed to their respective last known addresses, as shown by the files and records in this cause.
And it is further Ordered that public notice thereof be given by publication in a copy of this order once each week for three successive weeks previous to the date of hearing in the Birmingham Eccentric a newspaper printed and circulated in said county.
DONALD E. ADAMS, Judge of Probate. (25-26-27)

Women

(Continued from 1-D)



MRS. THEODORE O. YNTEMA

during the current year. They will make a most effective and experienced team," he says. Mrs. Yntema serves three other of the area's cultural organizations, the Detroit Symphony, the Cranbrook Music Guild and the Founders Society of the Detroit Museum of Art.

MRS. LYNN TOWNSEND

MRS. TOWNSEND, the daughter of a University of Michigan professor, was born in Detroit but spent her school and college days in Ann Arbor, graduating in 1940 from the University, where she majored in history. In the same year she married Lynn A. Townsend, her classmate. They are the parents of three sons. Besides being a member of the American Association of University Women, Mrs. Townsend has accompanied her husband on extensive travels to many parts of the world. Mrs. Yntema's husband, Theodore O. Yntema, is vice president of the Ford Motor Company and chairman of the company's finance committee. Mrs. Townsend is the wife of Lynn A. Townsend, president of the Chrysler Corporation.

Legal Notices

CITY OF BIRMINGHAM, MICHIGAN SEALED PROPOSALS REQUESTED Sealed proposals enclosed will be received at the office of the Superintendent of the Department of Public Works, 811 S. Ross Road, Birmingham, Alabama, until 2:00 P.M., September 3, 1963, after which time they will be publicly opened. The proposals will be for the furnishing of approximately 200 tons of 41 or C-4 Rock Salt during the bi-monthly period of 1963-4. The price bid to be on a unit basis, i.e., cost per ton. F.O.B. Detroit. The bidder must indicate whether or not he is willing to reduce the unit price to any level specified at which it may supply other purchasers during the term of the contract. All bids shall specify items. The Commission reserves the right to reject any or all bids, to waive any informality in the proposals received, and to accept any proposal which shall seem to be most favorable to the interests of the City.
T. C. BRIEN Superintendent, Dept. of Public Works (25)

Attic and Garage

A host of usable items you no longer need are to be found in the attic and garage . . . practically anything in fact from old baby items to tires. Get 'em out . . . shine them up . . . place your ad today!

Children and Playroom

Children's outgrown clothing and toys are very saleable at this time of the year! Call your ad in today!

Bedroom and Spare room

Now is the time to sell that spare bedroom set or bedtable lamps that are just catching dust. Phone your ad in today!

Living Room and Den

These areas offer a big source of saleable items from TV sets to books. Other people need them! Place your ad today!

Kitchen

There's always a market for appliances and other kitchen items. If you have any of these that you want to convert into cash, call your ad in now!

Basement

Clean up now . . . those items you have stored away are wanted by other people! You can call your ad in for anything . . . from a washing machine to outboard motors.

Bids Being Taken For Concessions At Porcupine Mts.

Bids are being taken by the Conservation Department for a five-year lease of the ski shelter concession at Porcupine Mountains state park which grossed more than \$17,000 during the 1962-63 winter season. Closing time for submitting lease offers is 2 p.m., Sept. 5. The concession covers the sale of refreshments and operation of services, including ski rentals, repairs, and instructions. It does not take in the park's ski tow business offered earlier this year under a long-term lease which failed to draw bidders. Bid proposal forms and a more detailed description of the concession may be obtained by writing to the department's parks and recreation division at Lansing.

DANCE CLASSES IN YOUR HOME TAUGHT BY JACK BARNES

2519 W. Maple MI. 7-1262 LI. 7-2933

Combination ALUMINUM STORMS Installed For You

WINDOWS \$15.50 DOORS \$39.95

We have Louvre Doors With Combination Screen & Glass

WOODCRAFT COMPANY Serving Satisfied Customers Since 1923 1184 Grant, S. of Lincoln MI 4-0424

BURIED TREASURE IN YOUR HOME CAN HELP YOU EARN EXTRA DOLLARS

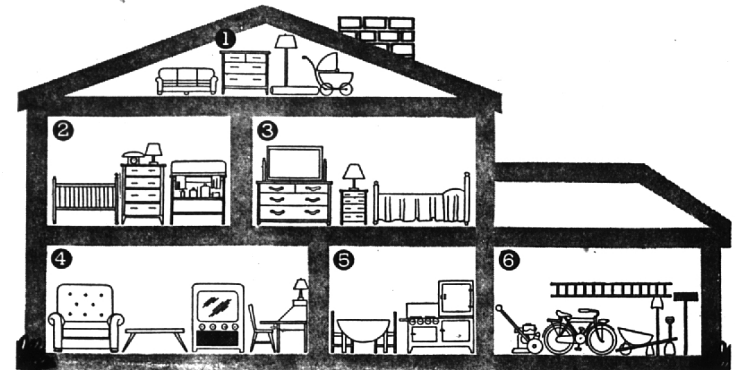

THERE ARE AT LEAST 8 PLACES

Attic and Garage

A host of usable items you no longer need are to be found in the attic and garage . . . practically anything in fact from old baby items to tires. Get 'em out . . . shine them up . . . place your ad today!

Children and Playroom

Children's outgrown clothing and toys are very saleable at this time of the year! Call your ad in today!

Bedroom and Spare room

Now is the time to sell that spare bedroom set or bedtable lamps that are just catching dust. Phone your ad in today!

Living Room and Den

These areas offer a big source of saleable items from TV sets to books. Other people need them! Place your ad today!

Kitchen

There's always a market for appliances and other kitchen items. If you have any of these that you want to convert into cash, call your ad in now!

Basement

Clean up now . . . those items you have stored away are wanted by other people! You can call your ad in for anything . . . from a washing machine to outboard motors.

3 TIMES \$2.70

Multiple exposure . . . now you can run a Classified Ad 3 TIMES FOR ONLY \$2.70 (Non-business-cash rate). It's easy, inexpensive and profitable . . . just dial Midwest 4-1100 and a pleasant and capable "ad-visor" will help you work out an ad to find the buyer you want.

AN EXPERIENCED AD WRITER WILL HELP YOU WRITE YOUR AD! PHONE MI 4-1100

The Birmingham Eccentric Classified Ads