

# NEWS OF BUSINESS

## Behind The Store Fronts



With **ANGUS MCKELLAR**

Nino T. Ambrosiano is the colorful new manager of Corning's Restaurant on Woodward Ave. just south of 11 Mile Road. A Birmingham resident for several years, he first started in the food business in Italy—then the famous Claridge Hotel in London, England.

But he says that his real career started when he began working on luxury ocean liners.

Following World War II he has been maître d'hôtel at some of America's finest establishments: the Colony Club, Ritz Carlton, Stork Club, Copacabana, Club 21, the Biltmore, and others, including, again, sea voyages aboard the Constitution and the Independence.

During his career, Ambrosiano has learned the food secrets of 32 countries and enough languages to make him feel at home anywhere, with any nationality.



**NINO T. AMBROSIANO**

Joe Scolaro, national advertising representative for The Birmingham Eccentric, is one of those rare individuals who will be able to glance at a mounted golf ball in his home and recall the thrill of that hole-in-one shot he made recently at Plum Brook Golf course near Utica. He used a No. 2 iron for the 203-yard drive.

Just about everyone in Birmingham knows Mrs. Bernice Baker at the Consumers Power Co.'s local office... and she is quite proud of that very healthy-looking diesel-beha plant which is responding beautifully to L.I.C. in the lobby.

Courtois recently returned from a buying trip to the Lamp and Decorators' Show in New York. Some of the new items have already arrived at the Birmingham Plaza store, Johnbee's (Telegraph at W. Maple).

Bill and Edith Smith are working long hours getting their new Early American furniture store in shape at 128 S. Woodward. They plan to open about Aug. 1. The Smiths have operated an Early American furniture store on the east side for 18 years. Smith's Early American Furniture & Accessories. They plan to move their residence to Birmingham in the near future.

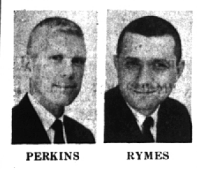

Bernice M. Krause and John P. Perkins

### Local Men Named Vice Presidents At Guerdon Inc.

Guerdon Industries, Inc. recently appointed two local men as vice presidents.

Robert Perkins, 5259 Echo Road, Bloomfield Hills, was appointed vice president, treasurer and assistant secretary. Charles Rymes, 156 Overhill, Birmingham, was appointed vice president—sales.

PERKINS HAS a B.A. from Albion College and an M.B.A. from the University of Michigan. He is a member of the Michigan C.P.A. and the American Institute of C.P.A.

Rymes holds a B.A. and a masters degree in business administration from the University of Michigan. He joined Guerdon Industries in 1961 as general sales manager—east, and previous to his new appointment was Guerdon's national sales manager.

The two men will be headquartered in the Guerdon Bldg., Southfield.

### Insurance Men, Families Attend Mackinac Confab

Mr. and Mrs. John H. Obee and their children, Pam, John and Dave of 4847 Wye Oak Road, Bloomfield Township, and Mr. and Mrs. Frank M. Mimminger, C.I.U., of 1995 Crosswick Road Birmingham, visited Mackinac Island June 26-29.

They were guests at the Grand Hotel, scene of a President's Club Conference, sponsored by Connecticut General Life Insurance Co.

President's Club is the company's top prestige organization composed of field representatives who meet standards of excellence in service to clients and in sales activity.

Obee and Mimminger are with the company's Detroit branch office.

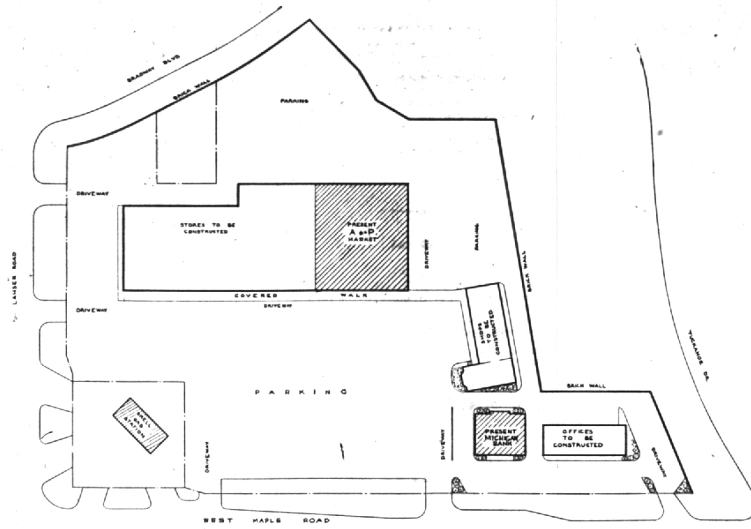

## New Shops Complete Village Mart

Bloomfield Village Mart, on the northeast corner of W. Maple and Lahser Roads, in which an A&P supermarket, a Shell gasoline station, and a Michigan Bank branch have already been constructed, will have added to it immediately several stores, shops and a medical building. Judson Broadway of the Judson Broadway Co., owners, says it will be developed as a high-fashion shopping center catering to the high purchasing power of the surrounding district. In the new construction, stores will be built west from the A&P

supermarket to Lahser, as well as a block of stores north from the bank building to the A&P. A medical building will be constructed east of the bank. Architects for the construction will be Charles N. Agree, Inc., who were the architects for the bank building and the supermarket already constructed. According to Broadway, parking will be available. "Although some of the space in the new buildings is spoken for, there are several choice locations still available," Broadway says.



**JAMES C. MCCLURE**

### Promoted

James C. McClure, 200 S. Williamsbury, Birmingham, has been promoted to vice president of Shopping Centers, Inc., the J. L. Hudson Co. subsidiary which owns and operates Northlawn Center and Eastland Center and has just started construction of Westland Center in Nankin Township. McClure has been with the company since 1952 and has been the assistant general manager in charge of Eastland Center since its opening in 1957. McClure is also a member of the International Council of Shopping Centers, the Detroit Board of Commerce, the Detroit Real Estate Board and the Builders Lodge No. 563 Masonic Lodge.

### Two Area Men Get New Positions In Advertising Co.

L. A. Winchell, 24428 Bloomington Road, Franklin, has been appointed Los Angeles district sales manager for Shaw-Barton, the Cocheton, advertising firm announced today. The transfer is a result of the company's expansion plans in Southern California.

Harold M. Brown, Jr., 2566 Cheswick Dr., Birmingham, has been appointed district manager here. He joined the company in 1954. He earned membership in the Shaw-Barton Triangle Club, a sales honorary, in 1955.

A graduate of Royal Oak High

School and the University of Michigan, Brown received his degree in engineering in 1949. He is married and has two children. He is a member of the Royal Oak Lions Club.

The Birmingham Eccentric Classified pages offer you a fine opportunity to sell your unwanted household goods.

### Products Company Tells Appointment

Detroit Automotive Products design, production and sale of die-cast, Detroit, has appointed Irving Hagglund as treasurer in addition to his other duties as vice president, sales.

Hagglund has been with the corporation for about 25 years. He lives at 5740 Sussex, Birmingham.

He has been instrumental in the

### DOUBLE DECKER COTS

Site 37"x74"x15" high  
 • Fabric — Duck  
 • Color — Olive Green  
 • Aluminum Frame

This Double Decker Cot can also be used as two single cots and when folded as shown above requires little storage space. Can be quickly set up or quickly disassembled.

**SPECIAL \$23.95**

### SPECIAL PURCHASE HODGEMAN AIR MATTRESS

Rubberized Canvas

Built in Pump **\$7.00** 74" x 34"

Seconds—Every One Guaranteed

WE GIVE S&H GREEN STAMPS

### THE SURPLUS SHACK

2923 N. WOODWARD (Between 12 1/2 and 13 Mile)

LI 9-9803

Open Sun. 10 to 4; Mon., Wed., Thurs., Fri. & Sat. 'til 9 p.m.

**MORE BUSINESS BRIEFS ON 6-E**

RESIDENTIAL COMMERCIAL ONE BUILDING OR MANY BUILDER BROKER INDIVIDUAL FHA CONVENTIONAL



## WE HAVE MORTGAGE MONEY

for new or used homes

Need funds to finance your property? Then Detroit Bank & Trust is the place to go.

Why? For two good reasons.

First, Convenience. You'll find our offices throughout Detroit and suburbs ready to serve you. What's more, to save you time, we'll even handle the closing at the office most convenient for you.

Second, Experience. When you deal with Detroit Bank & Trust, you're dealing with the most experienced bank in town. And this experience gives you an extra measure of sound guidance and assistance in determining the best kind of financing to suit your needs.

So, when you're planning your property financing, call on Detroit Bank & Trust for the kind of help you need most.

The Most Experienced Bank in town

**DETROIT BANK & TRUST**

MEMBER FDIC

• Woodward-Hamilton • Woodward-14 Mile  
 • Wabek Bldg. • Woodward-Oakland Drive-In Office

## for rooms you care about...

### PRE-FINISHED Panels

Beautiful Durable Maintenance-Free

Pre-finished plywood paneling is a beautiful, economical way to improve the appearance of those rooms you care about. It's easy to apply, too! See our display of this fine paneling material.

Choose From these Beautiful Panels Today—

SANDALWOOD, 1/4" x 4x8'	\$6.90
BATAAN, 1/4" x 4x8'	\$7.25
DRIFTWOOD, 1/4" x 4x8'	\$7.25
MAHOGANY, 1/4" x 4x8' (Natural)	\$5.10
WALNUT, (Premium) 1/4" x 4x8'	\$18.45
WALNUT, (Rustic) 1/4" x 4x8'	\$14.25
CERRY, 1/4" x 4x8' (Rustic)	\$12.25
BIRCH, 1/4" x 4x8' (Mountain)	\$10.45

**NEW BRUCE FRONTIER BIRCH**  
 Prefinished Paneling  
 1/4" x 4x8' **\$8.95**

Prices are cash and carry. Free Delivery on 10 pieces or more.

### TUXEDOS FOR HIRE

Quality to suit the finest occasion on a few hours notice. Sizes to suit equires of most every measure.

**Todd's GENTLEMEN'S SHOPS**

159 W. MAPLE BIRMINGHAM

## if the ROSE MAN wants to plan your vacation trip... hide the map!

...he can't find his way out of town. Yet, to your neighbor, your neighbor's neighbor and families everywhere, this fellow is an outright hero.

In fact he's almost becoming a legend. Strange? Not when you think about it. For instance, after he shows up, there's no more need to keep paying out good money for those "kill 'em quick", by guess and by golly insect-pest powders you've been futilely using.

Rose Home Service lets you relax and enjoy your home without sharing it with nasty ants in the kitchen, moths in the closet or mice in the basement.

And, no more worries about the dog or the kids sampling any highly toxic pest powders that might be spread around.

Even in homes clean enough to eat off the floor, roaches smuggle their way in. And unless you're smarter than they are, they stay.

That's where the Rose Man shines! He's a skilled, professional pest control expert. On regular inspections he provides preventive protection as well as immediate control, all for only pennies per day. You just can't buy his knowledge, his secret methods and modern materials at the corner store!

Call the Rose Man today and be safe!

**ROSE HOME SERVICE**  
 America's First Exterminating Service

**LI.5-2222**

### SCREEN DOORS

STURDY PINE 1 1/2" x 6 3/4"

Ready for New Home or Replacement. Comes Ready for Painting. Available in Aluminum or Galvanized wire.

Size	Price
24" X 6 3/4"	8.98
28" X 6 3/4"	9.39
30" X 6 3/4"	9.65

ALUMINUM WIRE

Size	Price
24" X 6 3/4"	12.25
28" X 6 3/4"	12.49
30" X 6 3/4"	13.25

### 1 x 12 SHELVING

6 Ft. and 8 Ft. Lengths

No. 3 White Pine

Ready for New Home or Replacement. Comes Ready for Painting. Available in Aluminum or Galvanized wire.

**10 1/2** Lin. Ft. C&C

### ACOUSTICAL CEILING TILE

• 12x12 white  
 • small hole design  
 • U.S. made

**12 1/2** sq. ft. c&c

### ASPHALT SHINGLES

New 235 lb. weight Bright new colors

**\$2.63** per Bdl. c&c

3 Bdl's covers 100 sq. ft.

### PATIO BLOCKS

8x16x1 1/4"

Many colors to choose from

**4 for \$1.00** (c&c)

### FOLDING STAIRWAY

Make Attic Handy for Storage

• Completely Assembled  
 • 25 1/2 x 54 Opening  
 • Fits Ceilings to 8'9"

**16.88** c&c

## FOR RESTRICK Lumber Company

3000 W. MAIN STREET, BIRMINGHAM, ALA. 35202

3000 W. MAIN STREET, BIRMINGHAM, ALA. 35202