

COMPLETE ASPHALT PAVING SERVICE

OAKLAND Paving Company

- Driveways
- Parking Areas
- Subdivisions

LI 6-5400
LI 6-2462



Get a Horse!

WHEEL HORSE, OF COURSE



The suburban tractor with 22 optional attaching tools to help you get more done—have more fun

There's a mountain of responsive muscle in this compact suburban tractor... with all the tools you need to make light of your yard work. Tiller, seeder, cultivator, rotary and reel type mowers, dump trailer and snow removal equipment are just a few of the work savers to know up with your Wheel Horse. No wonder so many smart folks are saying, "Get a horse" (Wheel Horse, of course!).

Ride a horse. Take a free test-drive, now.

• 5½ H.P. **\$449.00**

AS LOW AS

EASY TERMS — WE TAKE TRADE-INS

SPECIAL SALE . . . \$100 OFF (k.d.)

NEW 1961 RIDING TRACTORS

4½ H.P. . . . Was \$490 . . . Now **\$390**
5¾ H.P. . . . Was \$575 . . . Now **\$475**
7 H.P. . . . Was \$575 . . . Now **\$475**

MANUS POWER MOWERS, INC.

3116 N. Woodward Ave., Royal Oak
(2 blocks So. of 13 Mile Road)

Open 8 to 8 Daily—Saturday 8 to 6 P.M.—Sundays 10 a.m. to 2 p.m.

LI 9-2440

HAM STACK

Harry O. Smart
RSUOQ

One of our younger hams—junior operators as they are called by the elder members of the group—is Nancy Orton, KSQEI.

Nancy is a student at Groves High School and lives with her parents. Mr. and Mrs. James S. Orton of Riverside Drive, in Beverly Hills.

There are to hams in the Orton household, Nancy and her mother. Because Nancy is sightless, her mother helped her learn code and radio theory in order that she could pass the tests. Now, both are avid hams.

LOCAL HAM operators are liable to run into Nancy almost anywhere. Not only is she very active on the air but she also travels around the country to attend all sorts of meetings. She rarely misses a Hamvention if it is within 200 miles of Birmingham.

Nancy is considerate of those of us who have stiff wrists and slow minds—she will slow down to our speed if we ask her to.

The first time I saw her, she was operating a station on the tailgate of a station wagon during the 1960 field day exercises.

HER RIG WAS located at Kensington Metropolitan Park and she was operating one of the stations for the local radio club. Her mother was kept busy just writing up her contacts in the station log book.

For a while, Nancy attended the School for the Blind at Lansing. While she was there she kept in almost daily contact with her home by way of her own portable amateur station. In days gone by, this would have been all but impossible because of the cumbersome size of the equipment.

TODAY, HOWEVER, a station can be packed into a suitcase, accounting for the large numbers of portable amateur stations on college campuses all over the country. In fact, many of the schools today have their own amateur stations which have been built under the direction of the science teachers and are operated by the licensed hams who attend the schools.

In Basic Training

Douglas J. Winslow, son of Mr. and Mrs. J. Winslow of 5221 Sunngreat, Birmingham, began recruit training recently at the Naval Training Center, Great Lakes, Ill.



JUDGE DONALD ADAMS

Probate Judge Files for Re-Election

Probate Judge Donald E. Adams has filed nominating petitions for the Aug. 7 primary election and has thus far become the only candidate.

Judge Adams, 49, won a two-year term on the Probate Court bench in 1960 by defeating former state senator L. Harvey Ledde.

A veteran of 20 years as Waterford Township justice of the peace, Adams was graduated from the University of Michigan law school. He specializes in juvenile cases.

Changes Station

Airman Second Class Raymond D. Isaacson of Southfield, is being reassigned to a unit of the Pacific Air Force following his graduation from the United States Air Force technical training course for air armament mechanics here.

It's Quick, Easy and Thrifty
TO SHOP AT BIRMINGHAM LUMBER

BASKETBALL BACKBOARD SET \$9.95 Set Includes Rim and Net	FENCE MATERIAL 4x4 CEDAR 25¢ Lin. Ft. CEDAR POSTS 4" x 7 Ft. 69¢ ea. 48" PICKETS Clear Gothic Point 19¢ ea.	CEILING TILE VALUE!! VOLUME PURCHASE ALLOWS US TO SELL 12x12 WHITE TOP QUALITY 10¢ sq. ft. (66' Cart.—\$6.60)	READY MIX CEMENT OR MORTAR 95 Lb. Bag Picked up \$1.05
---	---	---	---

WE WILL HELP YOU DO IT YOURSELF, OR RECOMMEND A QUALIFIED CONTRACTOR

BIRMINGHAM LUMBER & SUPPLY COMPANY, INC.

1025 HAYNES CALL MI 4-3636

Between Adams & Hunter—5 Blocks South of Maple (East of Greenfield's)
Hours: Mon. Thru Fri. 7:30 to 5:30 P.M. — Sat. 7:30 to 4 P.M.

Birmingham Eccentric Want Ads Get Fast Results
Ask For Miss Classified—Dial Midwest 4-1100



*there are no disadvantages to this product**



WE STARTED OUT TO CREATE A REALLY EFFECTIVE, MULTI-PURPOSE GERMICIDE—ONE USE: SWIMMING AND WADING POOLS. — ONE THAT CONTROLLED ALGAE, FUNGI, AND BACTERIA WITHOUT QUESTION. **CONSAN DOES!** — ONE THAT WOULD ELIMINATE EYE, NOSE, OR SKIN IRRITATIONS RESULTING FROM HARSH CHEMICALS. **CONSAN DOES!** — ONE THAT LASTED LONGER BETWEEN APPLICATIONS. **CONSAN DOES!** — ONE THAT WOULD PROVE HARMLESS TO DELICATE SWIM-SUIT FABRICS. **CONSAN DOES!** — ONE THAT WOULD CUT THE COST OF POOL SANITIZING. **CONSAN DOES!** — WE COULDN'T FIND ANY DISADVANTAGES, AND WE KNOW YOU WON'T EITHER. — **ASK FOR CONSAN NOW AT YOUR LOCAL POOL-SUPPLY STORE, AND DEPARTMENT STORE, OR THROUGH YOUR POOL-SERVICE COMPANY.**

*Except that we must ask you to pay its reasonable price.

CONSAN CHEMICAL PRODUCTS / 7125 E. McNICHOLS RD. / DETROIT 12, MICHIGAN
A DIVISION OF MICHIGAN TOOL COMPANY
...PART OF EX-CELL-O CORPORATION / SOURCE OF SIGNIFICANT CONTRIBUTIONS TO INDUSTRY AND THE HOME

Kirkwood
... in Bloomfield

an exceptional residential community ...



the WILMINGTON . . . one of 5 distinctive homes now open . . . \$40,000

- 4 Large Bedrooms
- 2 1/2 beautiful baths
- Full basement
- two-story foyer

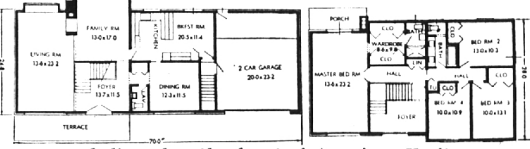

... dedicated to the finest of American Heritage

Kirkwood has been dedicated to the significant period of American history which began about 100 years ago. It was then that the people who lived on the land that is now Kirkwood found themselves involved directly and indirectly in the War Between the States. Their efforts, and the efforts of those who followed, helped make possible the bounties we enjoy today . . . the life possible for you and your family in Kirkwood. Here you will find a completely planned community with water, sewer, hard-surfaced roads and gas service which assure your family's comfort and well being. Kirkwood's select location amid rolling, wooded meadows is indeed a prime one. Your children will attend Birmingham schools. Excellent shopping in Birmingham and unique Franklin Village is most convenient. See Kirkwood today . . . choose your next, finer home here.

Sales information office open from 11 a.m. to 8 p.m. Monday through Friday and Sunday. On Saturday from 11 a.m. to 6 p.m. For information by telephone, please call: MAFair 6-7522.

Serving the People of Michigan Since 1924

THOMPSON-BROWN Company

19426 Grand River Avenue
Detroit 23, Michigan • KENwood 1-8700

Site of a Channel 2 Idea Home • Details at 9 a.m. & 5 p.m. Weekdays

