

# Here Are Attendance Areas for Birmingham Public Schools

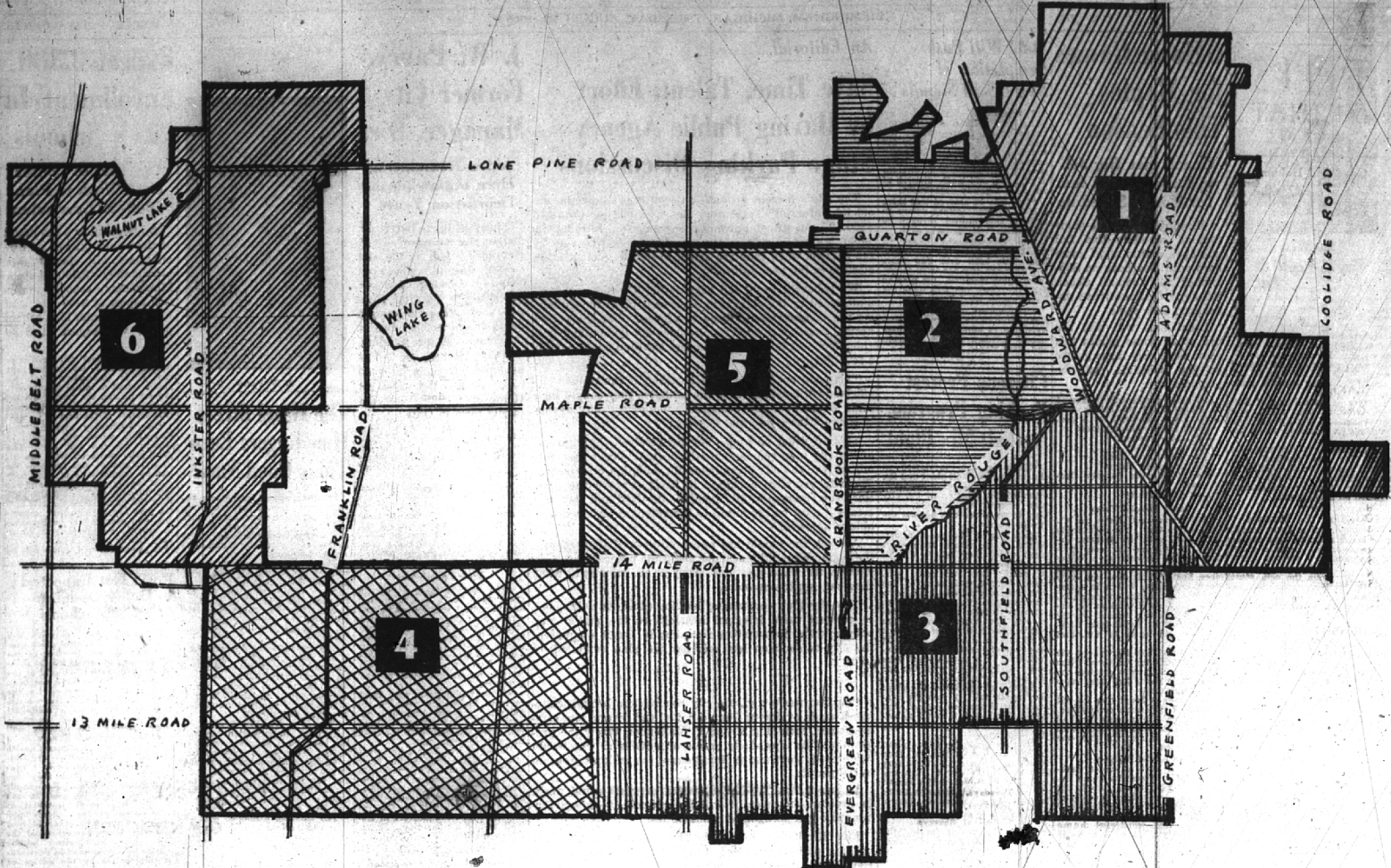

Many inquiries are coming in to the Board of Education daily from parents who are moving into the School District of the City of Birmingham and are anxious to know the school that serves their district. In connection with the above map of the school district, the following attendance areas are so defined that parents can easily determine the school which their child will attend.

**SENIOR HIGH SCHOOL:**  
All pupils in grades 10 through 12 will attend the Baldwin Senior High School, which is located at the corner of Maple and Chester streets.

**JUNIOR HIGH SCHOOL:**  
All pupils in grades 7 through 9 will attend Barnum Junior High School, which is located at the corner of Frank and Purdy streets.

**ADAMS ELEMENTARY SCHOOL:**  
All pupils in grades kindergarten through 6, and who reside east of Woodward Avenue, will attend Adams Elementary School—Area 1 on the map.

**QUARTON ELEMENTARY SCHOOL:**  
All pupils in grades kindergarten through 6, and who reside west of Woodward, north of River Rouge and Maple, and East of Cranbrook road, will attend Quarton Elementary School—Area 2 on the map. Children on Valley View Lane and Woodland Villa Court may attend Quarton School.

**PIERCE ELEMENTARY SCHOOL:**  
All pupils in grades kindergarten through 6, and who reside south of Maple from Woodward to River Rouge, south of River Rouge from Maple to Fourteen Mile Road, and south of Fourteen Mile Road from River Rouge to a line between Telegraph and Lahser Road, will attend Pierce Elementary School—Area 3 on the map.

**FRANKLIN ELEMENTARY SCHOOL:**  
All pupils in grades kindergarten through 6, and who reside south of Fourteen Mile road, east of Inkster road, west of line midway between Lahser road and Bingham road, will attend Franklin School, as shown on the map—Area 4.

**BLOOMFIELD VILLAGE ELEMENTARY SCHOOL:**  
All pupils in grades kindergarten through 6, and who reside west of Cranbrook road, and north of Fourteen Mile road, will attend Bloomfield Village Elementary School as shown on the map—Area 5.

**WALNUT LAKE ELEMENTARY SCHOOL:**  
All pupils in grades kindergarten through 6 will attend this school from the area as bounded on the map and marked "Area 6".

## Fire Danger Grows In Fall Months, Fire Chief Warns

According to Fire Chief V. W. Griffith, Birmingham continues to enjoy a period of almost no fires. During the month the department has answered 15 calls, with little or no property damage resulting from any of them.

"It has been an exceptionally good summer," Chief Griffith stated, "but we are entering a season of higher potential danger. With the approach of colder weather, fires will be started in furnaces which have not been checked and cleaned, and of course some calls will result from that source."

"Too, there will be calls to extinguish grass fires. As the season approaches for falling leaves our

calls always increase. Homeowners rake leaves and when they are thoroughly dry, burn them. The leaves are so light that the slightest breeze will carry burning embers into dry grass. We cannot caution residents too strongly to exercise the utmost care if they would prevent property damage during the next two or three months.

"Check furnaces and heating systems, and keep a constant guard on all bonfires is the best insurance homeowners can have during this time," Griffith said.

## Have You Met? . . .

Former Chicagoans, Mr. and Mrs. C. S. Bolek and their children Clark and Barbara Ann now residing at 1884 Humphrey. Mr. Bolek is with the International Revenue Department of the Federal Government.



**SHIRLEY AGAINST THE CHANNEL**—SHIRLEY May Francis, 16-year-old schoolgirl from Somerset, Miss., looks across the English Channel from Dover, England, to Cape Gris Nez, France. At Dover, Shirley May trained extensively for her bid to become the youngest person ever to swim the channel.

## Schools

(Continued from Page One)

B. Ireland, Superintendent of Schools, will address the teachers on "The Classroom Goes Home." Sectional meetings will also be held on Thursday afternoon. The elementary teachers will be addressed by Miss Lois Price, librarian, Detroit public schools on the "Literature Program in the Elementary Grades." After this lecture the teachers will divide into two groups, upper elementary and lower elementary. The upper elementary teachers will discuss problems with Miss Lois Price, and the lower elementary teachers will have Miss Mary Ethel O'Connor of Michigan State Normal College as their discussion leader.

The secondary school teachers will meet in groups at 10:30 a.m. The English group will be addressed by Miss Gwen Horsman, director of secondary reading program in the Detroit public schools. The social studies teachers will be addressed by Dr. Stanley Diamond, director of the citizenship study in Detroit. Dr. Diamond's address will be "The Social Studies Program in the Secondary School."

The science and mathematics teachers will be addressed by Everett Swanson, secretary-treasurer of the Radioactive Products Corporation in Detroit.

On Thursday evening a picnic will be held for all faculty members and the members of the board of education at Springdale Park at 5:30 p.m.

On Friday, Sept. 2, the proposed music program for the coming year will be presented by Arnold Berndt. The beauty and physical education program will be explained by Franklyn Whitney, and the new building program will be presented by Dr. Dwight B. Ireland.

On Friday afternoon building meetings will be conducted by the principals in their respective buildings.

## Planned Carefully

This program has been carefully planned by the administrative council of the Birmingham public schools to build morale, stimulate professional thinking, acquaint teachers with changes in the program of the school and the new building program, and provide opportunities for new teachers to meet former teachers and members of the board of education. It should provide the background and understanding which would go a long way toward guaranteeing a successful school year in 1940-50.

## Rooms, Apartments Sought Here For New Teachers

At this time of year newly employed teachers begin their search for rooms and moderately priced apartments. A number of places have been listed but more are needed.

Birmingham is unusual in that it does not have hotel facilities for temporary quarters, nor does it have rooms that are easily accessible to a newcomer who is not acquainted with the city. For the convenience of new teachers a list of rooms is kept in the office of the board of education, together with a street map of the city to direct teachers to the rooms and apartments listed. If Birmingham is to continue to have good teaching quarters for them and to create a center of information for their convenience.

Any one who has a room to spare is invited to list this room with the office of the board of education.

## Rationing Still Rigid in Scotland Travelers Report

By Lillian Diehrich

LATHRUP—Dr. and Mrs. Ford K. Daines of Quantico drive arrived home last week from a four-week vacation in Scotland, where they flew to visit Mrs. Daines' mother, Mrs. John Stobie and brother, John, of Edinburgh. They had not seen each other for 10 years, when the Stobies visited the States.

Their plane, carrying 40 passengers, took 14 flying hours from Montreal, and made only two stops to refuel at Nova Scotia and Gander.

Mrs. Daines reported the flights were smooth and the scenery on the return journey beautiful beyond description, especially over Iceland, the Arctic waste of Greenland and Labrador. At Gander where they refueled, a fog delayed them four hours.

## In Scottish Highlands

They spent 10 days in the heart of the highlands of Scotland.

land at Craiglunne hotel at Granton-on-Spoy, and from there went by rail to Inverness and Aberdeen. Hotel fare is very good, Mrs. Daines said, but rationing is as rigid as during the war. Only 25 cents worth of meat and one egg per person each week is allowed. Milk and dairy products are also strictly rationed.

There is a high purchase tax placed on all but utility clothing, making it prohibitive to have any luxuries, and fine woolens and tweeds are conspicuous by their absence on the streets of Scotland's cities. Some shops have woolens, which may be shipped tax free, but the Daines would have none of them under the circumstances imposed upon the natives.

The people of Scotland, noted for their staunch loyalty to their country, feel that economically they are sunk; there seems no way out, and the aftermath of two wars has left a telling effect," Mrs. Daines said.

## Parry

(Continued from Page One)

through the University in Ann Arbor. He returned to Birmingham in 1943 when he accepted a position with the labor relations department of General Motors.

A former member of the Birmingham Rotary club, Mr. Parry was a member of the First Methodist church, the Torch Club, past master of Birmingham Lodge No. 44, F. & A. M., the High Twelve club and Phi Mu Alpha, medical fraternity.

He is survived by his widow, the former Blanche Cline Parry, whom he married in Fargo, N. D.; a son, Donald Parry, of Birmingham; a daughter, Mrs. William Dale and grandchild, both of Brussels, Belgium; one brother, Carl E. Parry of Washington, D. C., and two sisters, Miss Edna Parry of Ann Arbor and Mrs. Lloyd Hyatt, Canton, Ohio.



**STARS OVER CHICAGO**—The "stars" in this unusual night photo of Chicago's skyline are 30,000,000 candlepower flares dropped by an Army B-17 bomber to help out the photographer. The flares, seen in the center of the sky, were fired from the plane at a three-second intervals.

**The Birmingham Eccentric**  
Published every Thursday at Birmingham, Mich., in the Eccentric Building, 212-214 North Woodward Ave.  
Telephone 11, 12, 13 and 14.  
Editor and Publisher  
Entered as Second Class Matter by the U. S. Post Office at Birmingham, Michigan, under the Act of March 3, 1919.  
**SUBSCRIPTION RATES**  
(in Oakland County)  
One Year . . . . . \$2.50  
Six Months . . . . . 1.75  
Three Months . . . . . 1.00  
(Outside Oakland County)  
One Year . . . . . \$3.50  
Six Months . . . . . 2.25  
Three Months . . . . . 1.25  
The Eccentric is a member of National Editorial Association, Michigan Press Association, and University Press Club.