

These are Attendance Areas for Birmingham Public Schools

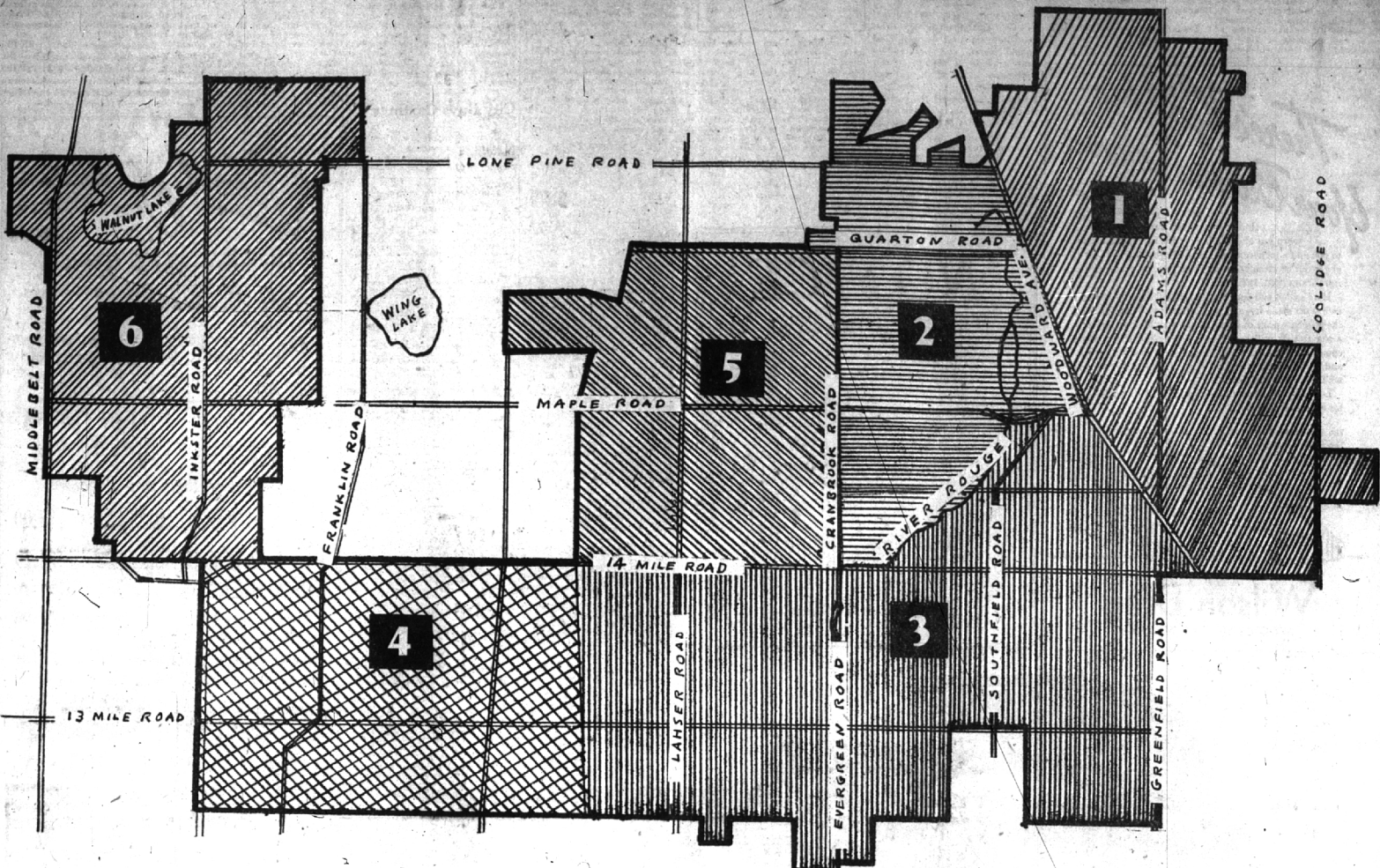

Many inquiries come to the Board of Education daily from parents who are moving into the School District of the City of Birmingham and are anxious to know the school that serves their district. A few modifications have been made in the southern part of the district, particularly in the Beverly Hills area, which parents should know prior to the opening of school. The following attendance areas are so defined that parents can easily determine the school which their child will attend.

SENIOR HIGH SCHOOL:
All pupils in grades 10 through 12 will attend the Baldwin Senior High School, which is located at the corner of Maple and Chester streets.

JUNIOR HIGH SCHOOL:
All pupils in grades 7 through 9 will attend Barnum Junior High School, which is located at the corner of Frank and Purdy streets.

ADAMS ELEMENTARY SCHOOL:
All pupils in grades kindergarten through 6, and who reside east of Woodward Avenue, will attend Adams Elementary School—Area 1 on the map.

QUARTON ELEMENTARY SCHOOL:
All pupils in grades kindergarten through 6, and who reside west of Woodward, north of River Rouge and Maple, and East of Cranbrook road, will attend Quarton Elementary School—Area 2 on the map. Children on Valley View Lane and Woodland Villa Court may attend Quarton School.

PIERCE ELEMENTARY SCHOOL:
All pupils in grades kindergarten through 6, and who reside south of Maple from Woodward to River Rouge, south of River Rouge from Maple to Fourteen Mile Road, and south of Fourteen Mile Road from River Rouge to a line between Telegraph and Lahser Road, will attend Pierce Elementary School—Area 3 on the map.

FRANKLIN ELEMENTARY SCHOOL:
All pupils in grades kindergarten through 6, and who reside south of Fourteen Mile road, east of Inkster road, west of a line midway between Lahser road and Bingham road, will attend Franklin School, as shown on the map—Area 4.

BLOOMFIELD VILLAGE ELEMENTARY SCHOOL:
All pupils in grades kindergarten through 6, and who reside west of Cranbrook road, and north of Fourteen Mile road, will attend Bloomfield Village Elementary School as shown on the map—Area 5.

WALNUT LAKE ELEMENTARY SCHOOL:
All pupils in grades kindergarten through 6 will attend this school from the area as bounded on the map and marked "Area 6."

Here it is! FORD "ENGINE TUNE-UP" SPECIAL!

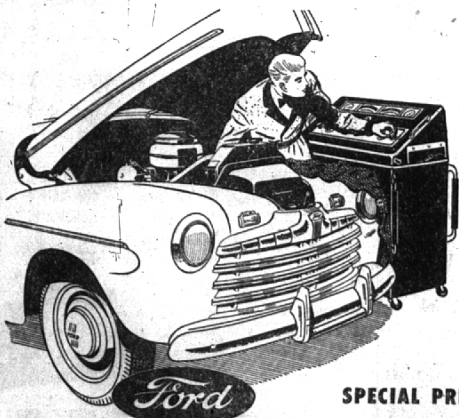

Here's What We Do:

- Remove and clean carburetor
- Adjust carburetor
- Check fuel pump
- Adjust distributor points
- Check distributor timing
- Check wiring
- Clean and adjust spark plugs
- Check generator
- Check battery cables
- Check fan belt
- Clean air filter
- Check voltage regulator

(Parts extra—if needed)

\$4.95

SPECIAL PRICE

For a limited time only!

TURN TO TURNER — YOUR FRIENDLY FORD DEALER

HAROLD TURNER, Inc.

464 S. Woodward

Phone 5000 or ELMhurst 5984

Your Ford Dealer Knows Fords Best

Y Camps Enjoy Good Season, Secretary Says

Edwin W. Kirbert, secretary of the local YMCA, who has just returned to his office after a vacation and visit to all the YMCA camps served by this community, states that the enrollment records

were tied or exceeded this past camp period by camps Nisokone, Ohlyesa, and Mah-Go-Tab-See.

Kirbert stated that it was by far the most successful season enjoyed by the camps in the last twenty-five years.

"More Birmingham boys were enrolled than in any previous year and a total of 17 boys attended camp through the generosity of Birmingham Merchants and members of the Rotary and Lions Club and interested individuals who were anxious to see some of the less fortunate youngsters of our community in camp," Kirbert said.

Gives Credit

Many of these scholarship boys, earned a good part of their fee by performing odd jobs.

"Much credit for the success of these camps is due to Eugene Hubbard, Baldwin high school teacher, who directed the program at Camp Ohlyesa, and had as three of his assistants Bill Elliott, Larry Bunyan, and Dick Dean; Dan Reilly and Ken Babcock who served under Douglas Salisbury at Nisokone; and Homer and Dorothy Roberts and Howard Sumner who worked as sectional heads at Camp Mah-Go-Tab-See," Kirbert concluded.

SCREENS AND STORM SASH
• WINDOWS
• CUPBOARD DOORS ALL SIZES
• FLUSH DOORS
WOODCRAFT CO.
1184 Grant at Ruffner

Read the **Detroit Free Press DAILY and SUNDAY**
For Local Home Delivery Phone **B'HAM 2363**

Over 23 Years Experience



RE-ELECT HUBBELL SHERIFF

Oakland County Republican
37 years resident of Oakland Co.

STATE OF MICHIGAN—In The Probate Court for the County of Oakland.

At a session of said Court, held in the Probate Office in the City of Pontiac, on said County, on the 21st day of August A.D. 1948.

Present, Honorable Arthur E. Moore, Judge of Probate.

In the Matter of the Estate of Emma J. Parks, Decedent.

It is Ordered, That the 27th day of September A.D. 1948 at nine o'clock in the forenoon, at said Probate Office, be and is hereby appointed for hearing said petition.

It is Further Ordered, That public notice thereof be given by publication of a copy of this order, each week, for three successive weeks previous to said day of hearing in the Birmingham Eccentric, a newspaper printed and circulated in said County.

ARTHUR E. MOORE, Judge of Probate 24-25-26

NOTICE AMENDMENT TO ORDINANCE NUMBER 221 ZONING ORDINANCE

Notice is hereby given that on Monday, September 28th, 1948, at 10 o'clock P. M., a public hearing will be held in the Commission Room of the Municipal Building in the City of Birmingham to consider an amendment to the Zoning Ordinance by adding thereto a new section, establishing property known as TOREANCE OIL COMPANY property, and more specifically described as that part of the north 30 acres of the east one-half of the west one-half of the northeast quarter lying southwesterly of the Detroit, Grand Haven and Milwaukee Railroad right of way in Section 21, Town 2 North, Range 11 East in the Industrial Zone.

IRENE E. HANLEY, City Clerk.

MIRACLE GRASS SHEARS

Makes lawn trimming a pleasure. Costs little more than ordinary types.

THE HEATH NURSERIES
Southfield Rd., south of 13 Mile

SALE

RUBBER GARDEN HOSE

5 8"	formerly \$6.75	now \$4.50
5 8"	formerly 8.75	now 5.80
5 8"	formerly 12.00	now 8.00
5 8"	formerly 15c ft.	now 12c ft. (remnants)
3 4"	formerly 20c ft.	now 14c ft.

DUSTERS and SPRAYERS — 25% OFF
GARDEN HAND TOOLS — 25% OFF
POWER MOWERS — REDUCED

McCLELLAN-BALL Co.

Yard - Garden - SUPPLIES - Kennel - Farm
BIRMINGHAM, MICHIGAN
Phone 314 159 Brownell St.