

**Dads vs. Daughters  
Ball Game Planned  
for GAA Picnic**

The annual GAA Pop's Night will be presented at Baldwin next Wednesday at six o'clock.

A dads vs. daughters baseball game is planned. Each girl will pack a picnic dinner for her father and herself.

The general chairman is Ann Lumbert, doing invitations are Barb Huesch, chairman, Mary Gilchrist, Sally Buck and Sherill Williams.

Food and refreshment committees are Kern McKay, Harry Patterson, Audrey Engel and Peggy Baldwin.

Mary Stringer, Carolyn Karch and Ginny Hood are taking charge of equipment.

The program is planned by Shirley Green, Ginny Matson, Jo Conder and Yvonne Engel.

**Floor Plan of the Cafeteria Addition to Barnum Junior High School**

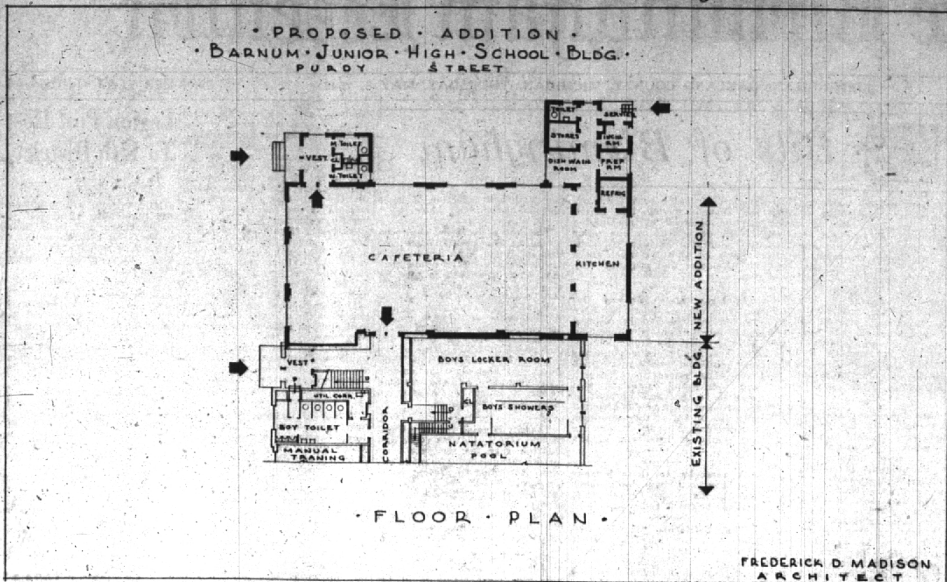

**New Sponsor Backs  
Local Ball Team**

Johnnie's Drive Inn will be the new title for last year's season champion for the Royal Oak League. A complete change has taken place, including a new home diamond. The "47" nine will compete in the Ferndale circuit, under ideal playing conditions. For convenience of the spectators, there is a large seating capacity, public address system, electric score board, and one of the finest

lighting setups in this area. First game is slated for May 31. All league games will be played on Wednesdays and Fridays.

Local color will be represented by nine Birmingham players. These are Don Fouraire, Bob Thompson, Dick Green, Scotty Gowans, Don Pursons, Jack Pearce, Larry Roudou, Cliff McBride, and 17-game-winner of last year's team, Ray McBride. Three Royal Oak players will also be signed to the roster.

Something to sell? Then try Eccentric Want Ads.

MERCURY MIKE SAYS:

**FOR REAL  
Mercury  
SERVICE  
ALWAYS SEE  
YOUR MERCURY  
DEALER**

WE USE  
FACTORY-  
APPROVED  
SERVICE  
METHODS

**TOM McDONNELL, INC.**  
850 South Woodward  
Phone 4101

**Woodward Hospital  
Benefit Concert  
Is Set for Tonight**

In order to benefit the Woodward General Hospital Building Fund, concertmaster Joseph Gindgold of the Detroit Symphony Orchestra will be at the Royal Oak High School auditorium tonight when he will be soloist of the evening with the South Oakland Symphony Orchestra.

With his friend and associate, Dirk von Emmert, first oboist of the Detroit Symphony, who is conductor of this amateur citizens' orchestra, he will lend his talent and time for the occasion.

Gindgold, after he finishes the present symphony season, leaves Detroit to join the Cleveland Symphony, so it will be one of the few remaining opportunities for

people of this area to hear him. Born in Breslau, Poland, of Russian-Polish descent, Gindgold started taking violin lessons at the age of 3 on a family-owned violin, the only one his father could afford. During World War I, when yet a youngster, he helped provide food and clothing for his family by playing in army camps. When the family found its way to New York, they used every effort to give young Joseph music lessons. Finally, at the age of 16, he made his debut at Town Hall and was hailed as a coming star.

Since then he has studied in Brussels under the great Eugene Ysaye, toured Europe, and played in the NBC Symphony, Primrose String Quartet, and many other great number of symphony orchestras as their guest before coming to Detroit.

Five numbers of the concert will be played by Gindgold.

**W. Maple Market  
Sold by Vitari**

Formal opening of the former Phil's Market on the west side of Birmingham will take place under new management this week and according to Nate Kaplan, new proprietor of the food store. It is located on West Maple at Chesterfield and will be known in the future as the Quorum Food Market.

Kaplan has been in the retail food business for the past 20 years, most of which were spent as proprietor of a store in Grosse Pointe. He sold out there two years ago and went to Los Angeles where he operated a market until his recent return to Michigan.

He purchased his present business from Phil Vitari who has operated a food market near that location for the past several years. Vitari completed the new building, which besides housing

the market contains Bette's Beauty Shop and Mills Pharmacy, last summer. He will retain ownership of the building.

Kaplan also announced that Bates Miller, who has operated the meat department in the store for the past year, will continue to do so. He also stated that a bakery department will be added in the near future.

**Well-Planned**

Smith, on the way to the city, found a slip of paper just outside the gate of his house. It was a detailed plan of his private office. The exact position of the stairs was shown. Notes showed which doors swung in and which swung out. Even the windows were set down. Smith, alarmed, rushed back into the house.

"Someone must be going to raid my office," he told his family. "Oh, it isn't that!" cried his daughter, glancing at the sketch. "Those notes are in John's handwriting. He's coming to your office today to ask you to let him marry me."

**CITY OF BIRMINGHAM, MICHIGAN  
NOTICE TO PROPERTY OWNERS  
FLYD STREET IMPROVEMENT—  
LINCOLN TO GEORGE**

The City Commission of the City of Birmingham will meet Monday, May 12th, 1947, at 11:00 A.M. in the Commission Room in the Municipal Building to consider any objection to the construction of certain improvements on Flyd Street, described herein, and for which petition has been filed; and to the creation of a special assessment district, created to defray the cost of construction of curb, gutter and gravel roadway, 24 ft. wide, with bituminous surfacing on Flyd Street, between Lincoln and George.

The Commission proposed to create a special assessment district to defray the cost of this construction and said special assessment district shall consist of the following described property:

Assessor's Plat No. 4—Lots 5, 6 and 7.  
Assessor's Plat No. 5—Lots 2, 4, 5, 6 and 8.  
Assessor's Plat No. 8—Lots 1 to 14 inclusive.

Beneficial Addition—Lots 54, 55, 56 and 60 to 67 Inc.  
Grove Addition—Lot 16.  
Lincoln Place—Lots 2, 3, 8, 9, 24 and 25.  
Lincoln Woodwards—Lots 1 to 4 Inc.  
Lincoln Sub—Lots 1 to 12 Inc.

Plans and estimates for this project are filed with the City Clerk of the City of Birmingham for examination by the public.

IRENE E. HANLEY,  
City Clerk.

**Sunday is Mothers' Day**

**Lentheric gifts  
are phrased in fragrance**

Phrase your gift in fragrance for it carries your wishes silently and softly.

Perfume for night-time splendour!  
Bouquet Lentheric for daytime charm!

Original one-ounce presentation of perfume and handsome decanter of Bouquet Lentheric clasped in fragrant union.

Tweed Miracle Confetti  
Shanghai and Dark Brilliance

**PERFUMES COLOGNES**  
\$3.75 to \$12.50 \$1.25 to \$2.50

Plus Federal Tax

**Wilson's**  
Woodward at Maple

**Presenting**

**BIRMINGHAM'S NEW QUALITY  
QUARTON  
FOOD MARKET**

Birmingham's most modern food market is now under new management and has been completely reorganized to serve you better. Here you will find not only the finest foods but the congenial atmosphere that makes shopping a pleasure. Plenty of parking area too.

1744 West Maple at Chesterfield Phones 1811 and 3726  
**FORMERLY PHIL'S MARKET**

Regular or Drip <b>MONARCH COFFEE</b> —lb. glass jar	49c
Campbell <b>TOMATO SOUP</b> —2 cans	19c
None Such <b>APRICOTS</b> (halves)—No. 2 1/2 can	35c
Silver Floor <b>SAUER KRAUT</b> —No. 2 1/2 can	10c
Del Monte <b>PINEAPPLE SLICES</b> —No. 1 cans	2 for 33c
Canadian Spruce <b>TOILET TISSUE</b> —2 rolls	25c
<b>PAPER NAPKINS</b> (80 count pkg.)—2 for	29c
<b>YACHT CLUB PEACHES</b> Halves in Syrup No. 2 1/2 can 39c	
<b>MONARCH Grapefruit Hearts</b> Whole Seedless Segments No. 2 can 23c	
None Such Spanish Stuffed <b>QUEEN OLIVES</b> 17-oz. jar 98c	
<b>CROSSE &amp; BLACKWELLS CHOW CHOW</b> 8 1/2-oz. jar 29c	
<b>RINSO</b> pkg. 35c	
<b>IVORY FLAKES</b> pkg. 35c	
<b>DREFT</b> pkg. 35c	
<b>CIGARETTES</b> All Popular Brands carton	<b>\$1.39</b>

**TOP Quality MEATS AND FINE Dairy Items**

Exclusive Dealers for Old Tavern Club

**CHEESE SPREADS**  
12 oz. pkg. 79c 14 oz. pkg. \$1.29  
The Aristocrat of cheese spreads

**BEEF STEAKS**  
Sirloin lb. 69c  
Porter House lb. 79c

**Honey Brand SLICED BACON**—lb. layer 61c

**KRAFT'S VELVEETA**  
2 lb. pkg. 85c  
1/2 lb. pkg. 24c

**Hy Grade PARTY LOAF**—12 oz. can 39c

**SHOULDER BEEF ROAST**  
for oven or pot lb. 45c

**PURE LARD**  
lb. pkg. 27c

**Pure Ground SHOULDER BEEF** lb. 39c

Any Brand **OLEOMARGARINE** lb. 43c

**Hy Gee DOG RATION** lb. can 10c

**Cross & Blackwell CLAM CHOWDER** No. 2 cans—2 for 35c

**Cross & Blackwell CREAM OF MUSHROOM SOUP** No. 2 cans—2 for 35c

**Cross & Blackwell CHICKEN NOODLE SOUP** No. 2 cans—2 for 35c

Chicken of the Sea **FANCY LIGHT MEAT TUNA**—7-oz. tin 45c

Premier Peaches **WHOLE KEIFFER PEARS**—No. 2 1/2 can 39c

**FRANCO AMERICAN SPAGHETTI**—2 cans 29c

**Texas Unsweetened GRAPEFRUIT JUICE**—46-oz. can 25c

**Farm Fresh Fruits and Vegetables**

**FLORIDA ORANGES** ORANGES  
2 doz. 21c 200 size 3 doz. \$1.00

U.S. No. 1 **NEW CALIFORNIA POTATOES** 10 lbs. 53c

We Have Fresh Strawberries, Mushrooms, Bananas, French Endive, Water Cress and Asparagus

We Also Carry a Complete Line of **BIRDS EYE FROZEN FOODS** and **LADY BORDEN ICE CREAM CONFECTIONS**