

HOME SITES.

If you are planning a Country Home, convenient to the City, let us call your attention to one of the best locations for this purpose between Detroit and Bloomfield Hills. Our new

Birmingham Heights

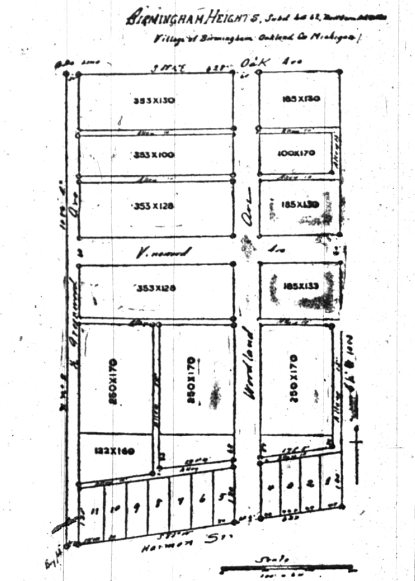

Subdivision.

Is right in the popular and fashionable district, only a block from Woodward Avenue, with 15-minute electric car service, 10-cent fare, and half an hour ride to city limits.

City Water, Cement Walks, Electric Light, Good Drainage, 600 feet above the Detroit River, and altogether ideal sanitary conditions.

Consider the rapid rise in Birmingham real-estate values for the past three years; no feverish boom, but a steady, reliable increase in values, due to the building of beautiful homes for the better class of home folks. Let us tell you about our easy terms and small payments—then make an investment. You cannot lose.

Short distance from the select private school—Bloomfield Hills Seminary—becoming popular among particular people.

Twelve large building sites, varying in size from 100x169 feet to 250x338 feet; soil a gravelly loam, fine for gardening, just what will appeal to you. Larger than a Village Lot, but small enough to dispense with the services of a care-taker.

Only 12 miles from the Detroit City Limits.

Restricted to Residences.

Numerous Beautiful homes have been built in the immediate vicinity during the past year.

Write us or call for terms and prices.

Whitehead & Mitchell
Birmingham Michigan

ESTABLISHED 1877

the REAL ESTATE EXCHANGE OF WHITEHEAD & MITCHELL

E. W. PICKARD

The following is a partial list of Farms, City and Village Lots, and Real Estate generally which we have for sale. As our list is constantly changing, we request that parties will write us if they do not see what they want in this list.

- No. 1. Fine residence practically new, 7 rooms, bath, toilet, furnace, electric light, lot 112 ft. front, 200 ft. deep, good barn, city water, 3 blocks to electric. Terms to suit.
- No. 2. Vacant lot in Buell addition fronting Woodward and electric. Fine building site cheap.
- No. 3. Vacant lot on Willow Avenue, 100 ft. front, 300 ft. deep, city water, fine lot of berries.
- No. 4. One thousand dollars cash and the balance on easy terms will buy 6 acres of excellent land on electric in Royal Oak village. 12 rooms for plating, 1,300 berries, 34 grapes, pretty little lake from which \$250 worth of ice was harvested last season, ten cents, and forty minutes to city hall, Detroit. Don't delay.
- No. 5. Here is a 1 1/2 Nine-room two-story cottage just finished, in fine location, lot 95x125, bath, toilet, furnace, electric light, five minutes walk to electric, good neighborhood, high and dry, \$2,600. There's no.
- No. 6. Delightful 1 1/2 acre residence, 4 rooms, bath, toilet, furnace, electric light, 140 ft. front, 205 ft. deep, lot 95x125, high and fine locality, price right and terms easy.
- No. 7. Eight rooms, 1 1/2 story cottage, hot water heater, bath, toilet, hot and cold water, barn, lot 40x103, two blocks from electric and \$2,600 cash will buy it.
- No. 8. Pine Lake cottage, 1 1/2 story, 4 rooms, bath, toilet, furnace, electric, one of the finest locations on this most beautiful portion of the lake region of Oakland county. Fine bathing, boating and fishing. Just the place to get rid of that tired feeling and patch up those nerves. Wait a minute, here's the price that will make you think it just fits your pocketbook. Go down in your jeans and buy it for \$1,600.
- No. 9. Two and one-half story residence on Maple Avenue, 12 rooms, furnace, city water, good barn, electric light, fine shade, about half an acre of land with fruit and the desirable qualities of one of the finest homes in Birmingham. Two blocks from electric. Look it over, come and see, a fine locality, offer for two cash and you'll see we help you get it.
- No. 10. Seven-room bungalow, latest improvements, bath, toilet, furnace, hot and cold water, electric light, good lot 60x180, nice barn, sewer, no better locality in town, high and dry, electric, 2 blocks from school, nice, new, cozy home for \$3,800. Take it away on easy terms and be happy.
- No. 11. Modern two-story frame dwelling with all the conveniences in Rochester, Mich., lot 60x120 with good barn, in good neighborhood, portable buildings insured for \$2,000, three blocks from electric and \$1,100 above the mortgage will buy it.
- No. 12. No. 12. Prettiest little farm in seven states. Just outside village of Birmingham, 19 acres, 3 blocks from electric, 1 1/2 acre of berries, 3 buildings, good water, high and dry, electric, modern 7-room dwelling, with city water and all conveniences such as bath, toilet, furnace, electric light, ideal place for city man with ideas regarding a little farm on the side. You and we call this a bargain. The price and terms won't frighten you if you mean business. No? Well; you just ask Whitehead and see.
- No. 13. Here's another. House and store in pleasant village, three blocks from electric. An acre and quarter of good land. Six room two-story cottage, bath, toilet, furnace, and barn; all in good shape. Fine chance for some one with small money to get a good living and something besides in country trade in rich farming community, and the terms are so easy that they won't worry you. Only \$1,000. Just scrape together enough to buy a small general stock and there you are.
- No. 14. Right in the center part of the village and valuable for business or residence. Lot 42x80, good comfortable, old fashioned house, lot rent for \$200 per month, but bless your heart, the land without any house at all is worth \$1,000. If you are looking for a home, you're from Missouri, you are just the fellow we want. Come on and we'll show you.
- No. 15. Lot in Campbell's subdivision, 60x120 new house, nice neighborhood, city water, furnace, etc., \$2,300. Terms so easy that you can't help pay for it if you just pay a little more than rent would come to. Then you would soon have a home of your own.
- No. 16. Good house and lot on Highland Avenue in the bustling village of 1,500. Will exchange for small farm property or \$2,400 will buy.
- No. 17. Farm of 147 acres in Oakland township, 125 cleared, 15 acres oak timber, house and barn, price \$45 per acre, one-half cash, balance on easy terms.
- No. 18. Good farm of 154 acres in Orion township, 70 acres under plow and balance in young growing timber, 1500 one-half cash, balance on easy terms.
- No. 19. Lot in Campbell's subdivision, 60x120 new house, nice neighborhood, city water, furnace, etc., \$2,300. Terms so easy that you can't help pay for it if you just pay a little more than rent would come to. Then you would soon have a home of your own.
- No. 20. Good house and lot on Highland Avenue in the bustling village of 1,500. Will exchange for small farm property or \$2,400 will buy.
- No. 21. Farm of 147 acres in Oakland township, 125 cleared, 15 acres oak timber, house and barn, price \$45 per acre, one-half cash, balance on easy terms.
- No. 22. Good farm of 154 acres in Orion township, 70 acres under plow and balance in young growing timber, 1500 one-half cash, balance on easy terms.
- No. 23. Good cottage on Watkins street, full basement, barn, chicken house, cement walk, two blocks from electric, \$2,700 above little mortgage, will land it and you'll have a home as good as any of 'em.
- No. 24. Twenty-five acre farm, 1 1/2 miles from Rochester, electric, small house, barn, two sheds, excellent land in high state of cultivation, easy terms, \$2,000.
- No. 25. Here's another \$2,000 home on Wiltside near electric, eighty feet front and 103 deep, seven room house, good cellar, beautiful maples shade the premises, and it is one that you could not build the house for the price asked. One of the many good things in our list, if not the best.
- No. 26. Forty acres of U. R. gravelly loam, good natural drainage, seven fine building sites, flowing well can be drained where desirable, 17 miles from Detroit, 1500 one-half cash, balance on easy terms, the small farms every one is crazy about just now, and \$200 per acre will buy it if you come quick with cash.
- No. 27. Bully little farm of 45 acres, 2 acres timber, 4 acres orchard, 1 1/2 miles from Detroit, 1500 one-half cash, balance on easy terms, the small farms every one is crazy about just now, and \$200 per acre will buy it if you come quick with cash.
- No. 28. Here's a little farm for your life; 25 acres, extremely fertile garden soil, with strawberries in bearing, 3 room, 2-story brick house improved, (very convenient), all necessary out-buildings, saw greenhouse, school and church within ten minutes walk, beautiful avenues of maples, one mile from electric, you can't find a better place for the price when you once go over the premises.
- No. 29. Yes; here's your chicken farm! seven and one-half acres on electric, about 1/2 miles from Detroit, 10 room house, bath, toilet, furnace, grate, electric light, good water, high and dry, 60 fine fruit trees just coming into bearing and \$5,000 will buy it.
- No. 30. Ten minutes from Woodward, 3 1/2 acre vacant on electric, 2 1/2 acre vacant with small buildings, (you could want to build sawmill, and the buildings are not considered in the price.) Just outside village limits, finest location, \$3,000.
- No. 31. Pretty little place half mile outside village limits, the grounds the best example of landscape gardening with trees, shrubs, etc., 7 1/2 acre vacant, high priced building, 1500 one-half cash, balance on easy terms, the small farms every one is crazy about just now, and \$200 per acre will buy it if you come quick with cash.
- No. 32. Five acres vacant on Willow Avenue, just outside corporation, 15 minutes walk from car, cement walk, fine for plating, will sell all for \$400 per acre, but we will sell for \$200 per acre. Will sell 60x125 from \$2.00 per front foot up, according to location.
- No. 33. Excellent farm of 160 acres on new State road, 20 acre orchard, 15 acre timber, buildings insured for \$5,000, only 3 1/2 miles from electric, will sell slightly above without buildings, old fashioned, but fine. Farm is 1500 one-half cash, balance on easy terms, the small farms every one is crazy about just now, and \$200 per acre will buy it if you come quick with cash.
- No. 34. Now, here's a farm for \$75 per acre and of course you will say it must be a poor one to sell for that, in these times, but it is not. First, show you how easily you can be mistaken, listen to this: One hundred and sixty acres of electric, high and dry, in good locality with comfortable buildings, barns rebuilt and a mile of new fence, 2 miles from electric, nice village country, 80 acres heavy loam and 80 lighter sandy loam. Preferred, all buildings insured for \$5,000. There's, we knew you would be interested. Detroit 15 miles.
- No. 35. If you could hear of a good farm for \$250 per acre, you'd be glad to begin to reach for things, what? Well, here you are: 10 acres of electric, high and dry, 1500 one-half cash, balance on easy terms, the small farms every one is crazy about just now, and \$200 per acre will buy it if you come quick with cash.
- No. 36. Southfield farm of 96 acres, new 8-room house, 2 barns and chicken house, all buildings in first class shape, stream runs through middle of farm, 2 acre orchard, no waste land, 1500 one-half cash, balance on easy terms, will exchange for Birmingham improved.
- No. 37. Sixteen acres in high state of cultivation, good 8-room house which needs but little expenditure to make modern improved, barn and chicken house, old fashioned, but fine. Farm is 1500 one-half cash, balance on easy terms, the small farms every one is crazy about just now, and \$200 per acre will buy it if you come quick with cash.
- No. 38. Here's another \$2,000 home on Wiltside near electric, eighty feet front and 103 deep, seven room house, good cellar, beautiful maples shade the premises, and it is one that you could not build the house for the price asked. One of the many good things in our list, if not the best.
- No. 39. Forty acres of U. R. gravelly loam, good natural drainage, seven fine building sites, flowing well can be drained where desirable, 17 miles from Detroit, 1500 one-half cash, balance on easy terms, the small farms every one is crazy about just now, and \$200 per acre will buy it if you come quick with cash.
- No. 40. Bully little farm of 45 acres, 2 acres timber, 4 acres orchard, 1 1/2 miles from Detroit, 1500 one-half cash, balance on easy terms, the small farms every one is crazy about just now, and \$200 per acre will buy it if you come quick with cash.
- No. 41. Yes; here's your chicken farm! seven and one-half acres on electric, about 1/2 miles from Detroit, 10 room house, bath, toilet, furnace, grate, electric light, good water, high and dry, 60 fine fruit trees just coming into bearing and \$5,000 will buy it.
- No. 42. Ten minutes from Woodward, 3 1/2 acre vacant on electric, 2 1/2 acre vacant with small buildings, (you could want to build sawmill, and the buildings are not considered in the price.) Just outside village limits, finest location, \$3,000.
- No. 43. Pretty little place half mile outside village limits, the grounds the best example of landscape gardening with trees, shrubs, etc., 7 1/2 acre vacant, high priced building, 1500 one-half cash, balance on easy terms, the small farms every one is crazy about just now, and \$200 per acre will buy it if you come quick with cash.
- No. 44. Five acres vacant on Willow Avenue, just outside corporation, 15 minutes walk from car, cement walk, fine for plating, will sell all for \$400 per acre, but we will sell for \$200 per acre. Will sell 60x125 from \$2.00 per front foot up, according to location.
- No. 45. Excellent farm of 160 acres on new State road, 20 acre orchard, 15 acre timber, buildings insured for \$5,000, only 3 1/2 miles from electric, will sell slightly above without buildings, old fashioned, but fine. Farm is 1500 one-half cash, balance on easy terms, the small farms every one is crazy about just now, and \$200 per acre will buy it if you come quick with cash.
- No. 46. Now, here's a farm for \$75 per acre and of course you will say it must be a poor one to sell for that, in these times, but it is not. First, show you how easily you can be mistaken, listen to this: One hundred and sixty acres of electric, high and dry, in good locality with comfortable buildings, barns rebuilt and a mile of new fence, 2 miles from electric, nice village country, 80 acres heavy loam and 80 lighter sandy loam. Preferred, all buildings insured for \$5,000. There's, we knew you would be interested. Detroit 15 miles.
- No. 47. If you could hear of a good farm for \$250 per acre, you'd be glad to begin to reach for things, what? Well, here you are: 10 acres of electric, high and dry, 1500 one-half cash, balance on easy terms, the small farms every one is crazy about just now, and \$200 per acre will buy it if you come quick with cash.
- No. 48. Southfield farm of 96 acres, new 8-room house, 2 barns and chicken house, all buildings in first class shape, stream runs through middle of farm, 2 acre orchard, no waste land, 1500 one-half cash, balance on easy terms, will exchange for Birmingham improved.
- No. 49. Sixteen acres in high state of cultivation, good 8-room house which needs but little expenditure to make modern improved, barn and chicken house, old fashioned, but fine. Farm is 1500 one-half cash, balance on easy terms, the small farms every one is crazy about just now, and \$200 per acre will buy it if you come quick with cash.
- No. 50. Here's another \$2,000 home on Wiltside near electric, eighty feet front and 103 deep, seven room house, good cellar, beautiful maples shade the premises, and it is one that you could not build the house for the price asked. One of the many good things in our list, if not the best.
- No. 51. Forty acres of U. R. gravelly loam, good natural drainage, seven fine building sites, flowing well can be drained where desirable, 17 miles from Detroit, 1500 one-half cash, balance on easy terms, the small farms every one is crazy about just now, and \$200 per acre will buy it if you come quick with cash.
- No. 52. Bully little farm of 45 acres, 2 acres timber, 4 acres orchard, 1 1/2 miles from Detroit, 1500 one-half cash, balance on easy terms, the small farms every one is crazy about just now, and \$200 per acre will buy it if you come quick with cash.
- No. 53. Yes; here's your chicken farm! seven and one-half acres on electric, about 1/2 miles from Detroit, 10 room house, bath, toilet, furnace, grate, electric light, good water, high and dry, 60 fine fruit trees just coming into bearing and \$5,000 will buy it.
- No. 54. Ten minutes from Woodward, 3 1/2 acre vacant on electric, 2 1/2 acre vacant with small buildings, (you could want to build sawmill, and the buildings are not considered in the price.) Just outside village limits, finest location, \$3,000.
- No. 55. Pretty little place half mile outside village limits, the grounds the best example of landscape gardening with trees, shrubs, etc., 7 1/2 acre vacant, high priced building, 1500 one-half cash, balance on easy terms, the small farms every one is crazy about just now, and \$200 per acre will buy it if you come quick with cash.
- No. 56. Five acres vacant on Willow Avenue, just outside corporation, 15 minutes walk from car, cement walk, fine for plating, will sell all for \$400 per acre, but we will sell for \$200 per acre. Will sell 60x125 from \$2.00 per front foot up, according to location.
- No. 57. Excellent farm of 160 acres on new State road, 20 acre orchard, 15 acre timber, buildings insured for \$5,000, only 3 1/2 miles from electric, will sell slightly above without buildings, old fashioned, but fine. Farm is 1500 one-half cash, balance on easy terms, the small farms every one is crazy about just now, and \$200 per acre will buy it if you come quick with cash.
- No. 58. Now, here's a farm for \$75 per acre and of course you will say it must be a poor one to sell for that, in these times, but it is not. First, show you how easily you can be mistaken, listen to this: One hundred and sixty acres of electric, high and dry, in good locality with comfortable buildings, barns rebuilt and a mile of new fence, 2 miles from electric, nice village country, 80 acres heavy loam and 80 lighter sandy loam. Preferred, all buildings insured for \$5,000. There's, we knew you would be interested. Detroit 15 miles.
- No. 59. If you could hear of a good farm for \$250 per acre, you'd be glad to begin to reach for things, what? Well, here you are: 10 acres of electric, high and dry, 1500 one-half cash, balance on easy terms, the small farms every one is crazy about just now, and \$200 per acre will buy it if you come quick with cash.
- No. 60. Southfield farm of 96 acres, new 8-room house, 2 barns and chicken house, all buildings in first class shape, stream runs through middle of farm, 2 acre orchard, no waste land, 1500 one-half cash, balance on easy terms, will exchange for Birmingham improved.
- No. 61. Sixteen acres in high state of cultivation, good 8-room house which needs but little expenditure to make modern improved, barn and chicken house, old fashioned, but fine. Farm is 1500 one-half cash, balance on easy terms, the small farms every one is crazy about just now, and \$200 per acre will buy it if you come quick with cash.
- No. 62. Here's another \$2,000 home on Wiltside near electric, eighty feet front and 103 deep, seven room house, good cellar, beautiful maples shade the premises, and it is one that you could not build the house for the price asked. One of the many good things in our list, if not the best.
- No. 63. Forty acres of U. R. gravelly loam, good natural drainage, seven fine building sites, flowing well can be drained where desirable, 17 miles from Detroit, 1500 one-half cash, balance on easy terms, the small farms every one is crazy about just now, and \$200 per acre will buy it if you come quick with cash.
- No. 64. Bully little farm of 45 acres, 2 acres timber, 4 acres orchard, 1 1/2 miles from Detroit, 1500 one-half cash, balance on easy terms, the small farms every one is crazy about just now, and \$200 per acre will buy it if you come quick with cash.
- No. 65. Yes; here's your chicken farm! seven and one-half acres on electric, about 1/2 miles from Detroit, 10 room house, bath, toilet, furnace, grate, electric light, good water, high and dry, 60 fine fruit trees just coming into bearing and \$5,000 will buy it.
- No. 66. Ten minutes from Woodward, 3 1/2 acre vacant on electric, 2 1/2 acre vacant with small buildings, (you could want to build sawmill, and the buildings are not considered in the price.) Just outside village limits, finest location, \$3,000.
- No. 67. Pretty little place half mile outside village limits, the grounds the best example of landscape gardening with trees, shrubs, etc., 7 1/2 acre vacant, high priced building, 1500 one-half cash, balance on easy terms, the small farms every one is crazy about just now, and \$200 per acre will buy it if you come quick with cash.
- No. 68. Five acres vacant on Willow Avenue, just outside corporation, 15 minutes walk from car, cement walk, fine for plating, will sell all for \$400 per acre, but we will sell for \$200 per acre. Will sell 60x125 from \$2.00 per front foot up, according to location.
- No. 69. Excellent farm of 160 acres on new State road, 20 acre orchard, 15 acre timber, buildings insured for \$5,000, only 3 1/2 miles from electric, will sell slightly above without buildings, old fashioned, but fine. Farm is 1500 one-half cash, balance on easy terms, the small farms every one is crazy about just now, and \$200 per acre will buy it if you come quick with cash.
- No. 70. Now, here's a farm for \$75 per acre and of course you will say it must be a poor one to sell for that, in these times, but it is not. First, show you how easily you can be mistaken, listen to this: One hundred and sixty acres of electric, high and dry, in good locality with comfortable buildings, barns rebuilt and a mile of new fence, 2 miles from electric, nice village country, 80 acres heavy loam and 80 lighter sandy loam. Preferred, all buildings insured for \$5,000. There's, we knew you would be interested. Detroit 15 miles.
- No. 71. If you could hear of a good farm for \$250 per acre, you'd be glad to begin to reach for things, what? Well, here you are: 10 acres of electric, high and dry, 1500 one-half cash, balance on easy terms, the small farms every one is crazy about just now, and \$200 per acre will buy it if you come quick with cash.
- No. 72. Southfield farm of 96 acres, new 8-room house, 2 barns and chicken house, all buildings in first class shape, stream runs through middle of farm, 2 acre orchard, no waste land, 1500 one-half cash, balance on easy terms, will exchange for Birmingham improved.
- No. 73. Sixteen acres in high state of cultivation, good 8-room house which needs but little expenditure to make modern improved, barn and chicken house, old fashioned, but fine. Farm is 1500 one-half cash, balance on easy terms, the small farms every one is crazy about just now, and \$200 per acre will buy it if you come quick with cash.
- No. 74. Here's another \$2,000 home on Wiltside near electric, eighty feet front and 103 deep, seven room house, good cellar, beautiful maples shade the premises, and it is one that you could not build the house for the price asked. One of the many good things in our list, if not the best.
- No. 75. Forty acres of U. R. gravelly loam, good natural drainage, seven fine building sites, flowing well can be drained where desirable, 17 miles from Detroit, 1500 one-half cash, balance on easy terms, the small farms every one is crazy about just now, and \$200 per acre will buy it if you come quick with cash.
- No. 76. Bully little farm of 45 acres, 2 acres timber, 4 acres orchard, 1 1/2 miles from Detroit, 1500 one-half cash, balance on easy terms, the small farms every one is crazy about just now, and \$200 per acre will buy it if you come quick with cash.
- No. 77. Yes; here's your chicken farm! seven and one-half acres on electric, about 1/2 miles from Detroit, 10 room house, bath, toilet, furnace, grate, electric light, good water, high and dry, 60 fine fruit trees just coming into bearing and \$5,000 will buy it.
- No. 78. Ten minutes from Woodward, 3 1/2 acre vacant on electric, 2 1/2 acre vacant with small buildings, (you could want to build sawmill, and the buildings are not considered in the price.) Just outside village limits, finest location, \$3,000.
- No. 79. Pretty little place half mile outside village limits, the grounds the best example of landscape gardening with trees, shrubs, etc., 7 1/2 acre vacant, high priced building, 1500 one-half cash, balance on easy terms, the small farms every one is crazy about just now, and \$200 per acre will buy it if you come quick with cash.
- No. 80. Five acres vacant on Willow Avenue, just outside corporation, 15 minutes walk from car, cement walk, fine for plating, will sell all for \$400 per acre, but we will sell for \$200 per acre. Will sell 60x125 from \$2.00 per front foot up, according to location.
- No. 81. Excellent farm of 160 acres on new State road, 20 acre orchard, 15 acre timber, buildings insured for \$5,000, only 3 1/2 miles from electric, will sell slightly above without buildings, old fashioned, but fine. Farm is 1500 one-half cash, balance on easy terms, the small farms every one is crazy about just now, and \$200 per acre will buy it if you come quick with cash.
- No. 82. Now, here's a farm for \$75 per acre and of course you will say it must be a poor one to sell for that, in these times, but it is not. First, show you how easily you can be mistaken, listen to this: One hundred and sixty acres of electric, high and dry, in good locality with comfortable buildings, barns rebuilt and a mile of new fence, 2 miles from electric, nice village country, 80 acres heavy loam and 80 lighter sandy loam. Preferred, all buildings insured for \$5,000. There's, we knew you would be interested. Detroit 15 miles.
- No. 83. If you could hear of a good farm for \$250 per acre, you'd be glad to begin to reach for things, what? Well, here you are: 10 acres of electric, high and dry, 1500 one-half cash, balance on easy terms, the small farms every one is crazy about just now, and \$200 per acre will buy it if you come quick with cash.
- No. 84. Southfield farm of 96 acres, new 8-room house, 2 barns and chicken house, all buildings in first class shape, stream runs through middle of farm, 2 acre orchard, no waste land, 1500 one-half cash, balance on easy terms, will exchange for Birmingham improved.
- No. 85. Sixteen acres in high state of cultivation, good 8-room house which needs but little expenditure to make modern improved, barn and chicken house, old fashioned, but fine. Farm is 1500 one-half cash, balance on easy terms, the small farms every one is crazy about just now, and \$200 per acre will buy it if you come quick with cash.
- No. 86. Here's another \$2,000 home on Wiltside near electric, eighty feet front and 103 deep, seven room house, good cellar, beautiful maples shade the premises, and it is one that you could not build the house for the price asked. One of the many good things in our list, if not the best.
- No. 87. Forty acres of U. R. gravelly loam, good natural drainage, seven fine building sites, flowing well can be drained where desirable, 17 miles from Detroit, 1500 one-half cash, balance on easy terms, the small farms every one is crazy about just now, and \$200 per acre will buy it if you come quick with cash.
- No. 88. Bully little farm of 45 acres, 2 acres timber, 4 acres orchard, 1 1/2 miles from Detroit, 1500 one-half cash, balance on easy terms, the small farms every one is crazy about just now, and \$200 per acre will buy it if you come quick with cash.
- No. 89. Yes; here's your chicken farm! seven and one-half acres on electric, about 1/2 miles from Detroit, 10 room house, bath, toilet, furnace, grate, electric light, good water, high and dry, 60 fine fruit trees just coming into bearing and \$5,000 will buy it.
- No. 90. Ten minutes from Woodward, 3 1/2 acre vacant on electric, 2 1/2 acre vacant with small buildings, (you could want to build sawmill, and the buildings are not considered in the price.) Just outside village limits, finest location, \$3,000.
- No. 91. Pretty little place half mile outside village limits, the grounds the best example of landscape gardening with trees, shrubs, etc., 7 1/2 acre vacant, high priced building, 1500 one-half cash, balance on easy terms, the small farms every one is crazy about just now, and \$200 per acre will buy it if you come quick with cash.
- No. 92. Five acres vacant on Willow Avenue, just outside corporation, 15 minutes walk from car, cement walk, fine for plating, will sell all for \$400 per acre, but we will sell for \$200 per acre. Will sell 60x125 from \$2.00 per front foot up, according to location.
- No. 93. Excellent farm of 160 acres on new State road, 20 acre orchard, 15 acre timber, buildings insured for \$5,000, only 3 1/2 miles from electric, will sell slightly above without buildings, old fashioned, but fine. Farm is 1500 one-half cash, balance on easy terms, the small farms every one is crazy about just now, and \$200 per acre will buy it if you come quick with cash.
- No. 94. Now, here's a farm for \$75 per acre and of course you will say it must be a poor one to sell for that, in these times, but it is not. First, show you how easily you can be mistaken, listen to this: One hundred and sixty acres of electric, high and dry, in good locality with comfortable buildings, barns rebuilt and a mile of new fence, 2 miles from electric, nice village country, 80 acres heavy loam and 80 lighter sandy loam. Preferred, all buildings insured for \$5,000. There's, we knew you would be interested. Detroit 15 miles.
- No. 95. If you could hear of a good farm for \$250 per acre, you'd be glad to begin to reach for things, what? Well, here you are: 10 acres of electric, high and dry, 1500 one-half cash, balance on easy terms, the small farms every one is crazy about just now, and \$200 per acre will buy it if you come quick with cash.
- No. 96. Southfield farm of 96 acres, new 8-room house, 2 barns and chicken house, all buildings in first class shape, stream runs through middle of farm, 2 acre orchard, no waste land, 1500 one-half cash, balance on easy terms, will exchange for Birmingham improved.
- No. 97. Sixteen acres in high state of cultivation, good 8-room house which needs but little expenditure to make modern improved, barn and chicken house, old fashioned, but fine. Farm is 1500 one-half cash, balance on easy terms, the small farms every one is crazy about just now, and \$200 per acre will buy it if you come quick with cash.
- No. 98. Here's another \$2,000 home on Wiltside near electric, eighty feet front and 103 deep, seven room house, good cellar, beautiful maples shade the premises, and it is one that you could not build the house for the price asked. One of the many good things in our list, if not the best.
- No. 99. Forty acres of U. R. gravelly loam, good natural drainage, seven fine building sites, flowing well can be drained where desirable, 17 miles from Detroit, 1500 one-half cash, balance on easy terms, the small farms every one is crazy about just now, and \$200 per acre will buy it if you come quick with cash.
- No. 100. Bully little farm of 45 acres, 2 acres timber, 4 acres orchard, 1 1/2 miles from Detroit, 1500 one-half cash, balance on easy terms, the small farms every one is crazy about just now, and \$200 per acre will buy it if you come quick with cash.
- No. 101. Yes; here's your chicken farm! seven and one-half acres on electric, about 1/2 miles from Detroit, 10 room house, bath, toilet, furnace, grate, electric light, good water, high and dry, 60 fine fruit trees just coming into bearing and \$5,000 will buy it.
- No. 102. Ten minutes from Woodward, 3 1/2 acre vacant on electric, 2 1/2 acre vacant with small buildings, (you could want to build sawmill, and the buildings are not considered in the price.) Just outside village limits, finest location, \$3,000.
- No. 103. Pretty little place half mile outside village limits, the grounds the best example of landscape gardening with trees, shrubs, etc., 7 1/2 acre vacant, high priced building, 1500 one-half cash, balance on easy terms, the small farms every one is crazy about just now, and \$200 per acre will buy it if you come quick with cash.
- No. 104. Five acres vacant on Willow Avenue, just outside corporation, 15 minutes walk from car, cement walk, fine for plating, will sell all for \$400 per acre, but we will sell for \$200 per acre. Will sell 60x125 from \$2.00 per front foot up, according to location.
- No. 105. Excellent farm of 160 acres on new State road, 20 acre orchard, 15 acre timber, buildings insured for \$5,000, only 3 1/2 miles from electric, will sell slightly above without buildings, old fashioned, but fine. Farm is 1500 one-half cash, balance on easy terms, the small farms every one is crazy about just now, and \$200 per acre will buy it if you come quick with cash.
- No. 106. Now, here's a farm for \$75 per acre and of course you will say it must be a poor one to sell for that, in these times, but it is not. First, show you how easily you can be mistaken, listen to this: One hundred and sixty acres of electric, high and dry, in good locality with comfortable buildings, barns rebuilt and a mile of new fence, 2 miles from electric, nice village country, 80 acres heavy loam and 80 lighter sandy loam. Preferred, all buildings insured for \$5,000. There's, we knew you would be interested. Detroit 15 miles.
- No. 107. If you could hear of a good farm for \$250 per acre, you'd be glad to begin to reach for things, what? Well, here you are: 10 acres of electric, high and dry, 1500 one-half cash, balance on easy terms, the small farms every one is crazy about just now, and \$200 per acre will buy it if you come quick with cash.
- No. 108. Southfield farm of 96 acres, new 8-room house, 2 barns and chicken house, all buildings in first class shape, stream runs through middle of farm, 2 acre orchard, no waste land, 1500 one-half cash, balance on easy terms, will exchange for Birmingham improved.
- No. 109. Sixteen acres in high state of cultivation, good 8-room house which needs but little expenditure to make modern improved, barn and chicken house, old fashioned, but fine. Farm is 1500 one-half cash, balance on easy terms, the small farms every one is crazy about just now, and \$200 per acre will buy it if you come quick with cash.
- No. 110. Here's another \$2,000 home on Wiltside near electric, eighty feet front and 103 deep, seven room house, good cellar, beautiful maples shade the premises, and it is one that you could not build the house for the price asked. One of the many good things in our list, if not the best.
- No. 111. Forty acres of U. R. gravelly loam, good natural drainage, seven fine building sites, flowing well can be drained where desirable, 17 miles from Detroit, 1500 one-half cash, balance on easy terms, the small farms every one is crazy about just now, and \$200 per acre will buy it if you come quick with cash.
- No. 112. Bully little farm of 45 acres, 2 acres timber, 4 acres orchard, 1 1/2 miles from Detroit, 1500 one-half cash, balance on easy terms, the small farms every one is crazy about just now, and \$200 per acre will buy it if you come quick with cash.
- No. 113. Yes; here's your chicken farm! seven and one-half acres on electric, about 1/2 miles from Detroit, 10 room house, bath, toilet, furnace, grate, electric light, good water, high and dry, 60 fine fruit trees just coming into bearing and \$5,000 will buy it.
- No. 114. Ten minutes from Woodward, 3 1/2 acre vacant on electric, 2 1/2 acre vacant with small buildings, (you could want to build sawmill, and the buildings are not considered in the price.) Just outside village limits, finest location, \$3,000.
- No. 115. Pretty little place half mile outside village limits, the grounds the best example of landscape gardening with trees, shrubs, etc., 7 1/2 acre vacant, high priced building, 1500 one-half cash, balance on easy terms, the small farms every one is crazy about just now, and \$200 per acre will buy it if you come quick with cash.
- No. 116. Five acres vacant on Willow Avenue, just outside corporation, 15 minutes walk from car, cement walk, fine for plating, will sell all for \$400 per acre, but we will sell for \$200 per acre. Will sell 60x125 from \$2.00 per front foot up, according to location.
- No. 117. Excellent farm of 160 acres on new State road, 20 acre orchard, 15 acre timber, buildings insured for \$5,000, only 3 1/2 miles from electric, will sell slightly above without buildings, old fashioned, but fine. Farm is 1500 one-half cash, balance on easy terms, the small farms every one is crazy about just now, and \$200 per acre will buy it if you come quick with cash.
- No. 118. Now, here's a farm for \$75 per acre and of course you will say it must be a poor one to sell for that, in these times, but it is not. First, show you how easily you can be mistaken, listen to this: One hundred and sixty acres of electric, high and dry, in good locality with comfortable buildings, barns rebuilt and a mile of new fence, 2 miles from electric, nice village country, 80 acres heavy loam and 80 lighter sandy loam. Preferred, all buildings insured for \$5,000. There's, we knew you would be interested. Detroit 15 miles.
- No. 119. If you could hear of a good farm for \$250 per acre, you'd be glad to begin to reach for things, what? Well, here you are: 10 acres of electric, high and dry, 1500 one-half cash, balance on easy terms, the small farms every one is crazy about just now, and \$200 per acre will buy it if you come quick with cash.
- No. 120. Southfield farm of 96 acres, new 8-room house, 2 barns and chicken house, all buildings in first class shape, stream runs through middle of farm, 2 acre orchard, no waste land, 1500 one-half cash, balance on easy terms, will exchange for Birmingham improved.
- No. 121. Sixteen acres in high state of cultivation, good 8-room house which needs but little expenditure to make modern improved, barn and chicken house, old fashioned, but fine. Farm is 1500 one-half cash, balance on easy terms, the small farms every one is crazy about just now, and \$200 per acre will buy it if you come quick with cash.
- No. 122. Here's another \$2,000 home on Wiltside near electric, eighty feet front and 103 deep, seven room house, good cellar, beautiful maples shade the premises, and it is one that you could not build the house for the price asked. One of the many good things in our list, if not the best.
- No. 123. Forty acres of U. R. gravelly loam, good natural drainage, seven fine building sites, flowing well can be drained where desirable, 17 miles from Detroit, 1500 one-half cash, balance on easy terms, the small farms every one is crazy about just now, and \$200 per acre will buy it if you come quick with cash.
- No. 124. Bully little farm of 45 acres, 2 acres timber, 4 acres orchard, 1 1/2 miles from Detroit, 1500 one-half cash, balance on easy terms, the small farms every one is crazy about just now, and \$200 per acre will buy it if you come quick with cash.
- No. 125. Yes; here's your chicken farm! seven and one-half acres on electric, about 1/2 miles from Detroit, 10 room house, bath, toilet, furnace, grate, electric light, good water, high and dry, 60 fine fruit trees just coming into bearing and \$5,000 will buy it.
- No. 126. Ten minutes from Woodward, 3 1/2 acre vacant on electric, 2 1/2 acre vacant with small buildings, (you could want to build sawmill, and the buildings are not considered in the price.) Just outside village limits, finest location, \$3,000.
- No. 127. Pretty little place half mile outside village limits, the grounds the best example of landscape gardening with trees, shrubs, etc., 7 1/2 acre vacant, high priced building, 1500 one-half cash, balance on easy terms, the small farms every one is crazy about just now, and \$200 per acre will buy it if you come quick with cash.
- No. 128. Five acres vacant on Willow Avenue, just outside corporation, 15 minutes walk from car, cement walk, fine for plating, will sell all for \$400 per acre, but we will sell for \$200 per acre. Will sell 60x125 from \$2.00 per front foot up, according to location.
- No. 129. Excellent farm of 160 acres on new State road, 20 acre orchard, 15 acre timber, buildings insured for \$5,000