

HOME SITES!

If you are planning a Country Home, convenient to the City, let us call your attention to one of the best locations for this purpose between Detroit and Bloomfield Hills. Our new

Birmingham Heights

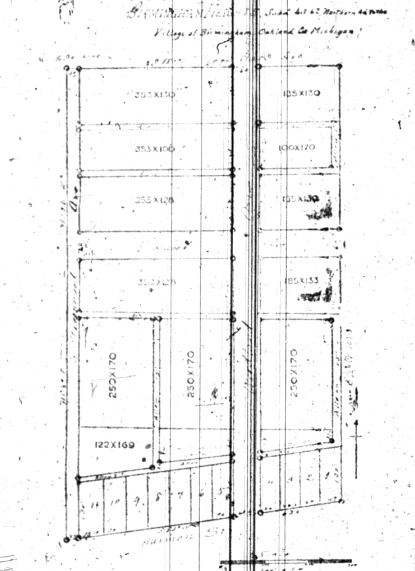

Subdivision!

Is right in the popular and fashionable district, only a block from Woodward Avenue, with 15-minute electric car service, 10-cent fare, and half an hour ride to city limits.

City Water, Cement Walks, Electric Light, Good Drainage, 600 feet above the Detroit River, and altogether ideal sanitary conditions.

Consider the rapid rise in Birmingham real-estate values for the past three years; no feverish boom, but a steady, reliable increase in values, due to the building of beautiful homes for the better class of home-folks. Let us tell you about our easy terms and small payments—then make an investment. You can't lose.

Short distance from the select private school—Bloomfield Hills Seminary—becoming popular among particular people.

Twelve large building sites, varying in size from 100x160 feet to 250x338 feet; soil a gravelly loam, fine for gardening, just what will appeal to you. Larger than a Village Lot, but small enough to dispense with the services of a care-taker.

Only 12 miles from the Detroit City Limits.

Restricted to Residents.

Numerous Beautiful homes have been built in the immediate vicinity during the past year.

Write us or call for terms and prices.

Whitehead & Mitchell

Birmingham Michigan

THE MONEY ASKED FOR THE M. A. C. MAY BE GIVEN DESPITE A HOSTILITY TO SNYDER.

THE SENATE APPROVES THE STATE GRANGE DEFENDS THE COLLEGE PRESIDENT.

The Short Ballot Bill Stands Little Chance of Going Through the Senate. Recall Cases Still Submitted at the Spring Election.

[By Gurd M. Hayes.] Despite the fact that a majority of the senate committee on the agricultural college are personally opposed to President J. L. Snyder, the Michigan Agricultural College, and some of the members of the house committee believe that a change in the management of the institution would be desirable, every effort will be made by the two committees to secure the increase of appropriation asked for by the state board of agriculture.

In order to get a line on the sentiment, Senator Fred Woodworth, chairman of the senate committee, called a conference between the two committees and the state board of agriculture. At the conference Woodworth informed the board that the prejudice against President Snyder was so strong that he did not believe it possible to get the appropriation of the institution increased. Senator Odell, who is also a member of the committee, said that the students at the college were unanimously opposed to the president and he declared that there was little sentiment in his favor among the alumni. He claimed also that the farmers of the state were not in sympathy with the institution.

N. P. Hitt, former master of the state grange, and the various members of the state board of agriculture rose to the defense of the president, and all the members of the board declared that they had been over the state and had heard nothing of the sentiment against the college which Odell and Woodworth claimed existed. In the end it was decided that the members of the board and the house senate committee should put forth their best efforts to secure the needed appropriation. Every one agreed that the institution was needed and that more money was needed to carry on the work.

Although the short ballot bill passed the house by unanimous vote, it has been sidetracked in the senate and stands little chance of getting through the legislature this session. Rep. Hitt, one of the progressive republicans who led the fight against the measure pointed out that it was not consistent to offer the people the primary and then take that right away from them as the result of a measure passed in the house. The Hitts measure which requires that butler must contain at least 81 per cent of butler fat and cream at least 18 per cent of milk fat, was also sidetracked by 7 to 2 and sent to the senate. Advocates of the measure asserted the standards required are those adopted by the general government, and it is desired the butler being sent to Michigan butler as well as to protect the buyer from purchasing a large quantity of water in his butter.

Butler and cream must hereafter be above standard as the result of a measure passed in the house. The Hitts measure which requires that butler must contain at least 81 per cent of butler fat and cream at least 18 per cent of milk fat, was also sidetracked by 7 to 2 and sent to the senate. Advocates of the measure asserted the standards required are those adopted by the general government, and it is desired the butler being sent to Michigan butler as well as to protect the buyer from purchasing a large quantity of water in his butter.

All doubts as to the progressive nature of the senate were dispelled when the upper house in a single afternoon passed the resolutions providing for the submission of constitutional amendments that would give the people of the state the initiative and referendum on legislation. The recall, the initiative and referendum on constitutional amendments and the short ballot.

Five years ago these measures would have been considered fit only for the discussion of a political party. Now they are being considered by the senate and the house, and it is a sign of the times that the people have taken to the initiative and referendum. It is a sign of the times that the people have taken to the initiative and referendum.

Senator Altschuld's horse power tax on automobiles which is a preliminary or auxiliary measure to the trunk line tax, is expected to be passed by the senate on this reading. This carries a tax of 50 cents per horse power on pleasure vehicles and 25 cents per horse power on commercial cars. The difference in commercial tax is due to the fact that commercial vehicles are practically all limited to the use of streets in cities and do not contribute to the wear on country roads.

Supporters of the proposed charter for Kalamazoo, who were defeated three weeks ago, have begun the circulation of petitions for the re-submission of the charter at the election April 7.

General administration with the administration of Mayor W. D. C. Germaine, who is now under charges of malfeasance in office, was one of the fastest in the county, as also was the high rate of taxation. The new charter will go into effect May 15.

Real Estate Exchange

OF WHITEHEAD & MITCHELL
Exchange Bank, Birmingham, Mich.

The following is a partial list of Farms, City and Village Lots and Real Estate generally which we have for sale. As our list is constantly changing, we request that parties will write us as if they do not see what they want in this list.

291. Fine new house with all modern conveniences, within 300 feet of the west end of Woodward Avenue. Good location, hardwood floors, hot water, electric lights, etc. Price \$12,000. Call for particulars. Well worth looking at.

292. Lot 4 in Block 2, Campbell's Subdivision, good house, insured for \$150; fine location, close to Woodward Avenue. Good house for some one with enough cash to make a small first payment.

293. New eight-room house, built last year in Village of Royal Oak, one block from Woodward Avenue. Good location, lot 50 feet front and 120 feet deep. Price \$7,500. Will sell for \$7,100.

294. House, barn, wagon shop, blacksmith shop, etc., on Woodward Avenue. Good location, lot 50 feet front and 120 feet deep. Price \$12,000. Will sell for \$11,000.

295. One of the nice ones on the Hill. Adjoining lot, facing on Woodward Ave. 20 feet front and 120 feet deep. Good location, lot 50 feet front and 120 feet deep. Price \$7,500. Will sell for \$7,100.

296. New brick house, two blocks from Woodward Avenue. Good location, lot 50 feet front and 120 feet deep. Price \$7,500. Will sell for \$7,100.

297. Excellent business chance in a small building. Fine chance for some one with small capital. Good location, lot 50 feet front and 120 feet deep. Price \$7,500. Will sell for \$7,100.

298. Fine farm of 120 acres in the midst of the Bloomfield Hills. A little over a mile from the electric near Mt. Pleasant. Good location, lot 50 feet front and 120 feet deep. Price \$7,500. Will sell for \$7,100.

299. If quality in farming lands is what you want, this is the place. Good location, lot 50 feet front and 120 feet deep. Price \$7,500. Will sell for \$7,100.

300. Twenty-two acres, a mile east of the electric in Royal Oak. Ten-room house, good location, lot 50 feet front and 120 feet deep. Price \$7,500. Will sell for \$7,100.

301. Twenty-two acres, a mile east of the electric in Royal Oak. Ten-room house, good location, lot 50 feet front and 120 feet deep. Price \$7,500. Will sell for \$7,100.

302. Fine farm of 120 acres in the midst of the Bloomfield Hills. A little over a mile from the electric near Mt. Pleasant. Good location, lot 50 feet front and 120 feet deep. Price \$7,500. Will sell for \$7,100.

303. If quality in farming lands is what you want, this is the place. Good location, lot 50 feet front and 120 feet deep. Price \$7,500. Will sell for \$7,100.

304. Twenty-two acres, a mile east of the electric in Royal Oak. Ten-room house, good location, lot 50 feet front and 120 feet deep. Price \$7,500. Will sell for \$7,100.

305. Twenty-two acres, a mile east of the electric in Royal Oak. Ten-room house, good location, lot 50 feet front and 120 feet deep. Price \$7,500. Will sell for \$7,100.

306. Twenty-two acres, a mile east of the electric in Royal Oak. Ten-room house, good location, lot 50 feet front and 120 feet deep. Price \$7,500. Will sell for \$7,100.

307. House and two lots on Willow street, half block from Woodward Avenue. Good location, lot 50 feet front and 120 feet deep. Price \$7,500. Will sell for \$7,100.

308. Lot 4 in Block 2, Campbell's Subdivision, good house, insured for \$150; fine location, close to Woodward Avenue. Good house for some one with enough cash to make a small first payment.

309. New eight-room house, built last year in Village of Royal Oak, one block from Woodward Avenue. Good location, lot 50 feet front and 120 feet deep. Price \$7,500. Will sell for \$7,100.

310. House, barn, wagon shop, blacksmith shop, etc., on Woodward Avenue. Good location, lot 50 feet front and 120 feet deep. Price \$12,000. Will sell for \$11,000.

311. One of the nice ones on the Hill. Adjoining lot, facing on Woodward Ave. 20 feet front and 120 feet deep. Good location, lot 50 feet front and 120 feet deep. Price \$7,500. Will sell for \$7,100.

312. New brick house, two blocks from Woodward Avenue. Good location, lot 50 feet front and 120 feet deep. Price \$7,500. Will sell for \$7,100.

313. Excellent business chance in a small building. Fine chance for some one with small capital. Good location, lot 50 feet front and 120 feet deep. Price \$7,500. Will sell for \$7,100.

314. Fine farm of 120 acres in the midst of the Bloomfield Hills. A little over a mile from the electric near Mt. Pleasant. Good location, lot 50 feet front and 120 feet deep. Price \$7,500. Will sell for \$7,100.

315. If quality in farming lands is what you want, this is the place. Good location, lot 50 feet front and 120 feet deep. Price \$7,500. Will sell for \$7,100.

316. Twenty-two acres, a mile east of the electric in Royal Oak. Ten-room house, good location, lot 50 feet front and 120 feet deep. Price \$7,500. Will sell for \$7,100.

317. Twenty-two acres, a mile east of the electric in Royal Oak. Ten-room house, good location, lot 50 feet front and 120 feet deep. Price \$7,500. Will sell for \$7,100.

318. Fine farm of 120 acres in the midst of the Bloomfield Hills. A little over a mile from the electric near Mt. Pleasant. Good location, lot 50 feet front and 120 feet deep. Price \$7,500. Will sell for \$7,100.

319. If quality in farming lands is what you want, this is the place. Good location, lot 50 feet front and 120 feet deep. Price \$7,500. Will sell for \$7,100.

320. Twenty-two acres, a mile east of the electric in Royal Oak. Ten-room house, good location, lot 50 feet front and 120 feet deep. Price \$7,500. Will sell for \$7,100.

321. Twenty-two acres, a mile east of the electric in Royal Oak. Ten-room house, good location, lot 50 feet front and 120 feet deep. Price \$7,500. Will sell for \$7,100.

322. Fine farm of 120 acres in the midst of the Bloomfield Hills. A little over a mile from the electric near Mt. Pleasant. Good location, lot 50 feet front and 120 feet deep. Price \$7,500. Will sell for \$7,100.

323. If quality in farming lands is what you want, this is the place. Good location, lot 50 feet front and 120 feet deep. Price \$7,500. Will sell for \$7,100.

324. House and two lots on Willow street, half block from Woodward Avenue. Good location, lot 50 feet front and 120 feet deep. Price \$7,500. Will sell for \$7,100.

325. Lot 4 in Block 2, Campbell's Subdivision, good house, insured for \$150; fine location, close to Woodward Avenue. Good house for some one with enough cash to make a small first payment.

326. New eight-room house, built last year in Village of Royal Oak, one block from Woodward Avenue. Good location, lot 50 feet front and 120 feet deep. Price \$7,500. Will sell for \$7,100.

327. House, barn, wagon shop, blacksmith shop, etc., on Woodward Avenue. Good location, lot 50 feet front and 120 feet deep. Price \$12,000. Will sell for \$11,000.

328. One of the nice ones on the Hill. Adjoining lot, facing on Woodward Ave. 20 feet front and 120 feet deep. Good location, lot 50 feet front and 120 feet deep. Price \$7,500. Will sell for \$7,100.

329. New brick house, two blocks from Woodward Avenue. Good location, lot 50 feet front and 120 feet deep. Price \$7,500. Will sell for \$7,100.

330. Excellent business chance in a small building. Fine chance for some one with small capital. Good location, lot 50 feet front and 120 feet deep. Price \$7,500. Will sell for \$7,100.

331. Fine farm of 120 acres in the midst of the Bloomfield Hills. A little over a mile from the electric near Mt. Pleasant. Good location, lot 50 feet front and 120 feet deep. Price \$7,500. Will sell for \$7,100.

332. If quality in farming lands is what you want, this is the place. Good location, lot 50 feet front and 120 feet deep. Price \$7,500. Will sell for \$7,100.

333. Twenty-two acres, a mile east of the electric in Royal Oak. Ten-room house, good location, lot 50 feet front and 120 feet deep. Price \$7,500. Will sell for \$7,100.

334. Twenty-two acres, a mile east of the electric in Royal Oak. Ten-room house, good location, lot 50 feet front and 120 feet deep. Price \$7,500. Will sell for \$7,100.

335. Fine farm of 120 acres in the midst of the Bloomfield Hills. A little over a mile from the electric near Mt. Pleasant. Good location, lot 50 feet front and 120 feet deep. Price \$7,500. Will sell for \$7,100.

336. If quality in farming lands is what you want, this is the place. Good location, lot 50 feet front and 120 feet deep. Price \$7,500. Will sell for \$7,100.

337. Twenty-two acres, a mile east of the electric in Royal Oak. Ten-room house, good location, lot 50 feet front and 120 feet deep. Price \$7,500. Will sell for \$7,100.

338. Fine farm of 120 acres in the midst of the Bloomfield Hills. A little over a mile from the electric near Mt. Pleasant. Good location, lot 50 feet front and 120 feet deep. Price \$7,500. Will sell for \$7,100.

339. If quality in farming lands is what you want, this is the place. Good location, lot 50 feet front and 120 feet deep. Price \$7,500. Will sell for \$7,100.

340. Twenty-two acres, a mile east of the electric in Royal Oak. Ten-room house, good location, lot 50 feet front and 120 feet deep. Price \$7,500. Will sell for \$7,100.

341. House and two lots on Willow street, half block from Woodward Avenue. Good location, lot 50 feet front and 120 feet deep. Price \$7,500. Will sell for \$7,100.

342. Lot 4 in Block 2, Campbell's Subdivision, good house, insured for \$150; fine location, close to Woodward Avenue. Good house for some one with enough cash to make a small first payment.

343. New eight-room house, built last year in Village of Royal Oak, one block from Woodward Avenue. Good location, lot 50 feet front and 120 feet deep. Price \$7,500. Will sell for \$7,100.

344. House, barn, wagon shop, blacksmith shop, etc., on Woodward Avenue. Good location, lot 50 feet front and 120 feet deep. Price \$12,000. Will sell for \$11,000.

345. One of the nice ones on the Hill. Adjoining lot, facing on Woodward Ave. 20 feet front and 120 feet deep. Good location, lot 50 feet front and 120 feet deep. Price \$7,500. Will sell for \$7,100.

346. New brick house, two blocks from Woodward Avenue. Good location, lot 50 feet front and 120 feet deep. Price \$7,500. Will sell for \$7,100.

347. Excellent business chance in a small building. Fine chance for some one with small capital. Good location, lot 50 feet front and 120 feet deep. Price \$7,500. Will sell for \$7,100.

348. Fine farm of 120 acres in the midst of the Bloomfield Hills. A little over a mile from the electric near Mt. Pleasant. Good location, lot 50 feet front and 120 feet deep. Price \$7,500. Will sell for \$7,100.

349. If quality in farming lands is what you want, this is the place. Good location, lot 50 feet front and 120 feet deep. Price \$7,500. Will sell for \$7,100.

350. Twenty-two acres, a mile east of the electric in Royal Oak. Ten-room house, good location, lot 50 feet front and 120 feet deep. Price \$7,500. Will sell for \$7,100.

351. Twenty-two acres, a mile east of the electric in Royal Oak. Ten-room house, good location, lot 50 feet front and 120 feet deep. Price \$7,500. Will sell for \$7,100.

352. Fine farm of 120 acres in the midst of the Bloomfield Hills. A little over a mile from the electric near Mt. Pleasant. Good location, lot 50 feet front and 120 feet deep. Price \$7,500. Will sell for \$7,100.

353. If quality in farming lands is what you want, this is the place. Good location, lot 50 feet front and 120 feet deep. Price \$7,500. Will sell for \$7,100.

354. Twenty-two acres, a mile east of the electric in Royal Oak. Ten-room house, good location, lot 50 feet front and 120 feet deep. Price \$7,500. Will sell for \$7,100.

355. Twenty-two acres, a mile east of the electric in Royal Oak. Ten-room house, good location, lot 50 feet front and 120 feet deep. Price \$7,500. Will sell for \$7,100.

356. Fine farm of 120 acres in the midst of the Bloomfield Hills. A little over a mile from the electric near Mt. Pleasant. Good location, lot 50 feet front and 120 feet deep. Price \$7,500. Will sell for \$7,100.

357. If quality in farming lands is what you want, this is the place. Good location, lot 50 feet front and 120 feet deep. Price \$7,500. Will sell for \$7,100.