

# GREAT AUCTION SALE!

## BIRMINGHAM REAL ESTATE.

Thursday, August 30, 1900, at 1 P. M. Sharp, on the Premises,

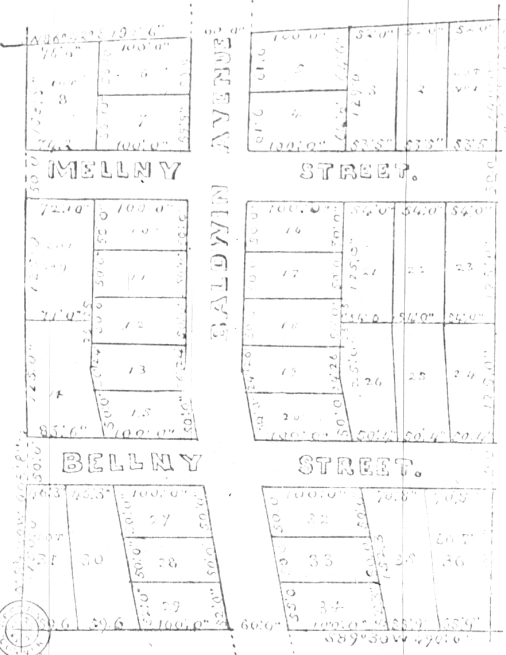

Whitehead & Mitchell Addition,  
VILLAGE OF BIRMINGHAM,  
MICHIGAN,  
1900.

AND

# GRAND FREE DANCE

IN THE EVENING,

## AT ELECTRIC PARK, BIRMINGHAM.

COME ONE AND ALL!

To round up the sale of our lots in a proper manner we have decided to give a Free Dance, to which we invite all our friends. Every patron of ours in the Store, every subscriber to the Eccentric, or any member of the family, are invited. In fact all will be welcome.

Music by Gilboe's fine band of five pieces.  
Floor managers, A. Whitehead and Geo. H. Mitchell.

Good order will be maintained and everybody is expected to be present and dance from 7 to 12 o'clock. Cars will run in connection with the dance and all will be sent home in good shape at a reasonable hour. Come and enjoy yourselves.

You are Welcome.

**WHITEHEAD & MITCHELL.**

Whitehead & Mitchell will Sell 36 Desirable Lots Known as the  
Whitehead & Mitchell Addition to the Village of Birmingham at Auction.

**Every Lot will be Sold to the Highest Bidder.**

This will be a rare opportunity to purchase a home or a profitable investment. The lots are well located and will sell at a price and on terms which will make it possible for a large number of people to own a home.

Nearly every lot is a good one, nicely located, and you will see from the map that a large number of them are better located than a large portion of the city. They are a really good investment and a home in Birmingham are further away than our most distant lots. Best soil, good water, and a fine view, are not necessary for our lots. Everybody will see that these lots are the best of the city and the best of the village.

**Birmingham is a Desirable Home Village for the Following Reasons:**

Birmingham is a growing, thriving village, never had a boom, never had a crash. It is one of the best ten years is something marvelous; our new hotel hotels, representing thousands of dollars, are being built by their owners, all prove that real estate is always growing here and more and more every day.

**Advantages of Birmingham for a Home.**

- Population, 120,000. Our taxes are light, being less than \$2.50 per \$100 assessed in any city in the state.
- The finest climate and healthiest located village near Detroit, being not but across the river, the Detroit river, with the best class of people on earth to associate with.
- One of the finest schools in the state. Our school for a number of years, showing a record of 100 per cent money received for foreign tuition averages with the best in Michigan that has a population of 100,000.
- Five fine churches, Methodist, Presbyterian, St. James Episcopal, Baptist, African Methodist Episcopal, and others, for the spiritual welfare of our village and surrounding territory.
- Only twelve miles from the city limits of Detroit on Woodward Avenue.
- Detroit A. Postoffice, Electric Railway runs every half hour from the city to the village.
- D. G. H. A. M. R. runs three times a week to Detroit and there is a fine view of the city.
- Birmingham has the best waterworks system in the state. Water is piped to every lot and is under direct pressure to the many users in our village.
- Dr. C. M. Rayburn says for fifteen years because of our fine waterworks system, there has not been a malignant case of scarlet fever, an ideal place to rear a family for health and happiness.

**What We Sell.**

Whitehead & Mitchell will sell for cash or on special terms, 36 lots in the Whitehead & Mitchell Addition, the new Baldwin street, on a north-south line, in the village of Birmingham, Michigan, and the streets, including every advantage of a home.

**Why We Sell.**

This property is located in the best of the city. We are not going through a pantomime of success. We are not going through a pantomime of success. We are not going through a pantomime of success. We are not going through a pantomime of success.

### TERMS OF SALE:

In order to accommodate all and make it possible for any one to own a home or secure the best investment for the small-est saving the following very liberal terms have been decided upon: Ten per cent of purchase price at time of sale. Ten per cent more on delivery of contract in thirty days, the balance within two years in weekly, monthly or quarterly payments with interest at the very low rate of 5 per cent per annum; payments as small as one dollar will be accepted and every payment stops interest. Title perfect, a printed abstract with every lot. Save your money 50 cts. to one dollar per week would soon pay for a lot. Suitable Building Restrictions will be Made Known on Day of Sale.

**M. H. BLUNT,**  
AUCTIONEER.

**WHITEHEAD & MITCHELL,**  
PROPRIETORS.